

G-9205
56354
79432
T 7615
T 8763

T.25S., R.18E., W.M.

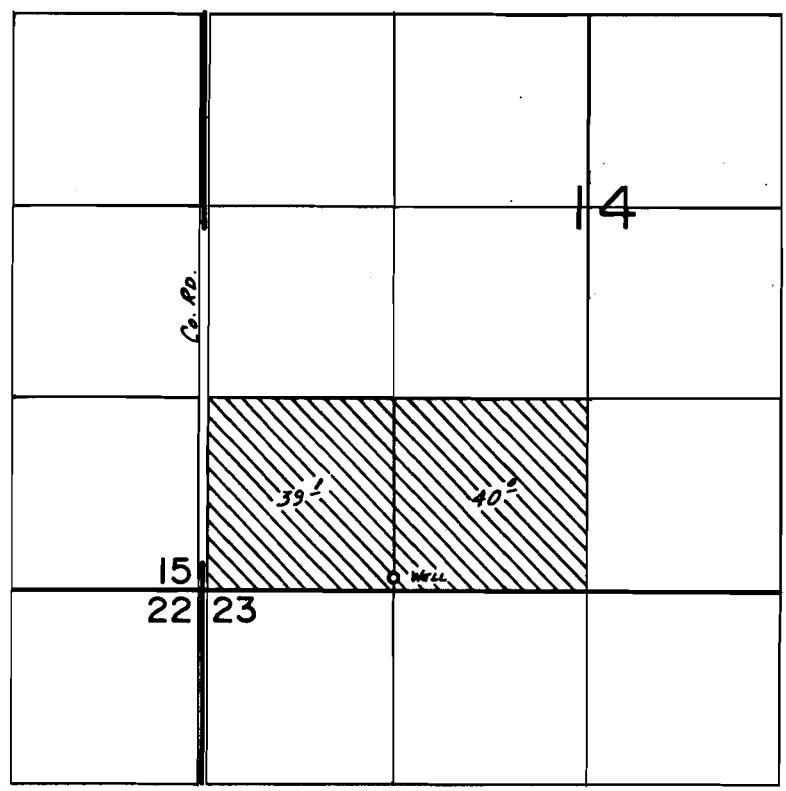

WELL LOC.: 80' N. & 1320' E. FROM SW COR. SEC. 14

SCALE: 1"=1320'

FINAL PROOF SURVEY UNDER

Application No. G-10168 Permit No. G-9205....
IN NAME OF

.....WILLIAM V. KERGIL.....

Surveyed Sept. 12, 1985, by B.W. BISHOP.....
Oct. 28, 1986, VES GARNER

1-21-87
GWS

PTS 1985L
INSPECTION