

T.5S. R.2W., W.M.

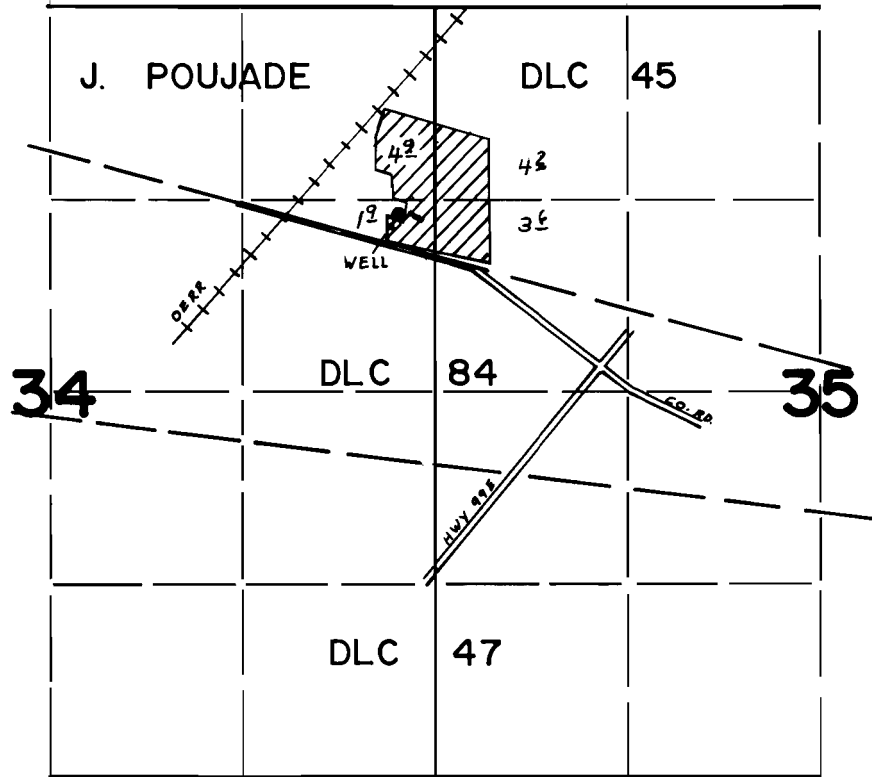

WELL LOC. 1420 S. & 250 W. FROM NE COR. SEC. 34

FINAL PROOF SURVEY UNDER

Application No. G-7861 Permit No. G-7286
IN NAME OF

SAVVA KALUGIN

Surveyed JUNE 7, 1979, by L. H. NUNN