

# T.35S.,R.7W.,W.M.

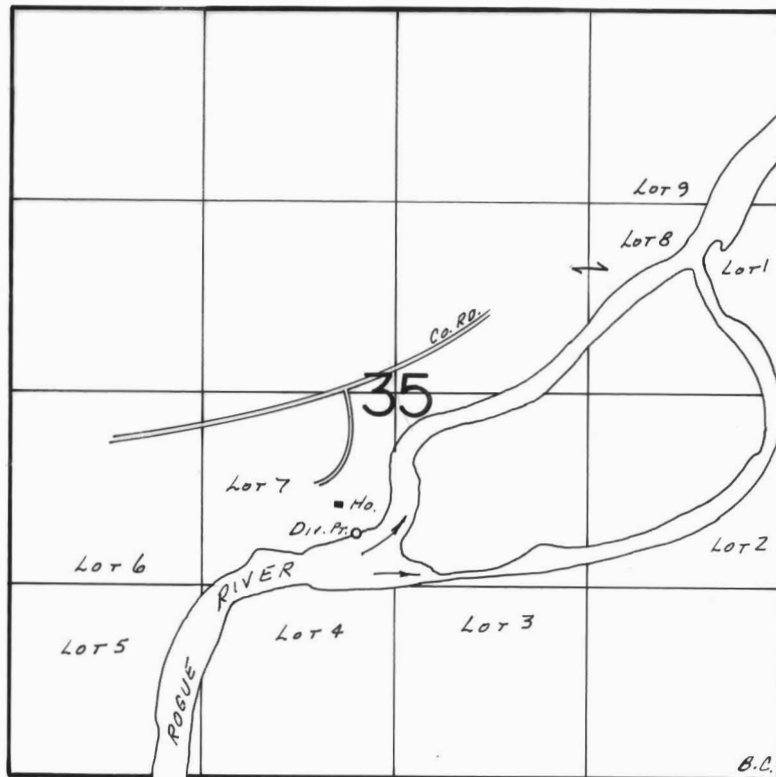

DIV. PT. LOC.: 1690' N. & 2900' W. FROM SE COR. SEC. 35

SCALE: 1" = 1320'

## FINAL PROOF SURVEY UNDER

Application No. 58307... Permit No. 43890.....  
IN NAME OF

.....EDGAR A. IMRIE.....

Surveyed Oct. 23... 19.85, by B.S. JAMES.....