

# T. 15S., R. 4W., W.M.

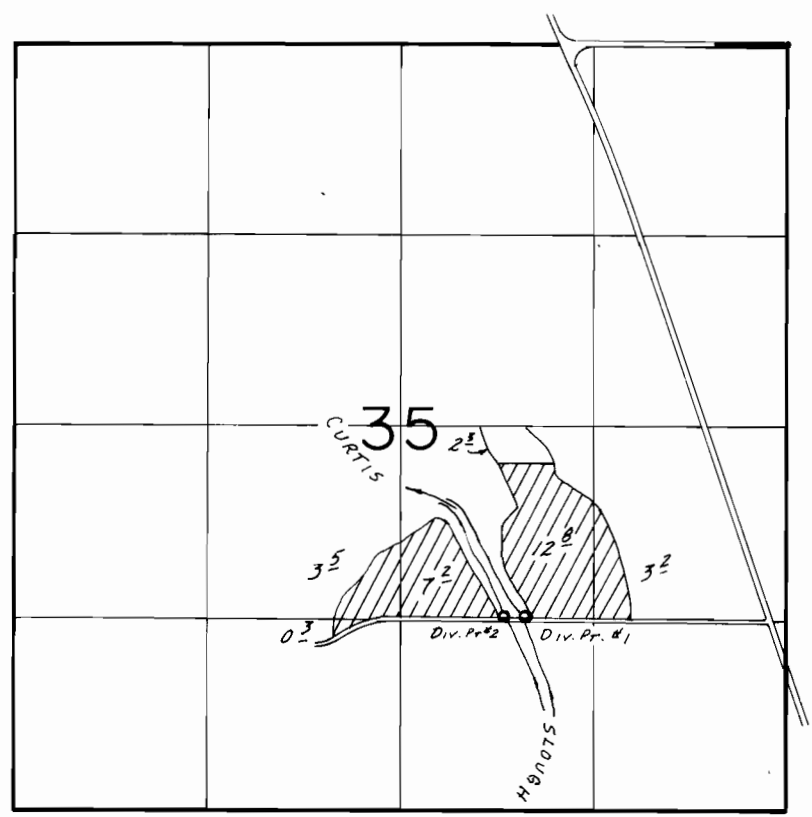

DIV. PTS. LOC.: #1- 1350' N. & 1800' W.; #2- 1350' N. & 1930' W., BOTH FROM SE COR. SEC. 35.

SCALE: 1" = 1320'

## FINAL PROOF SURVEY UNDER

Application No. 59547... Permit No. 45634.....  
IN NAME OF

**D2OG JOINT VENTURE**

Surveyed May 20... 1986, by B.W. BISHOP.....

11/7/86  
BWB