

RECEIVED

FEB 17 1977



WATER RESOURCES DEPT.  
OREGON

T.4S., R.1E., W.M.

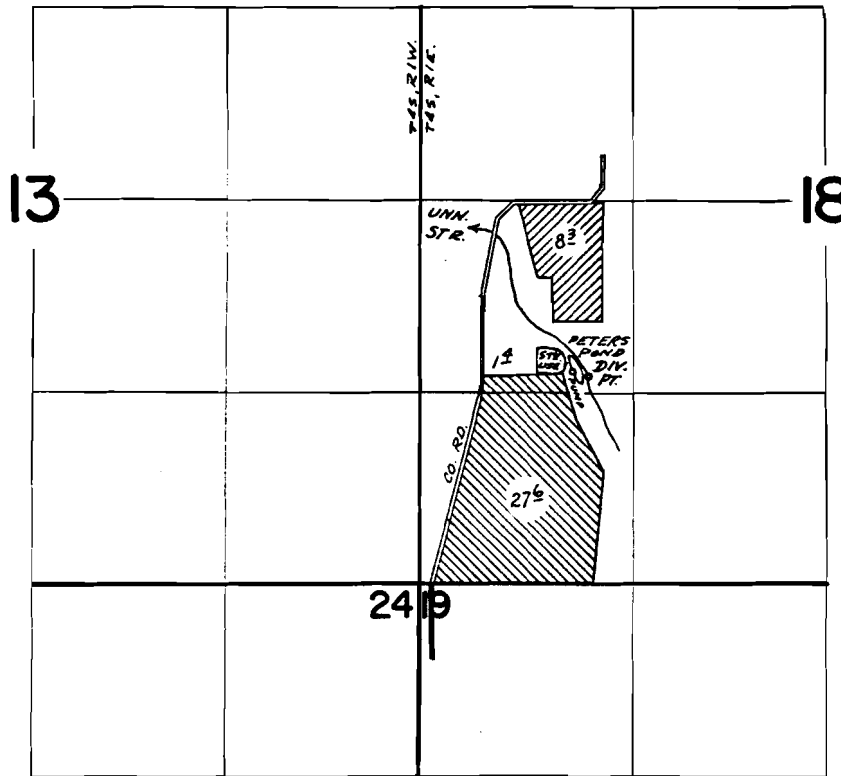
Application No. 55269  
Permit No. 44141



DIV. PT. LOCATED: 1420' N & 1150' E FROM SW COR. SEC. 18.  
POND LOCATED: 1450' N & 1090' E FROM SW COR. SEC. 18.

-  PRIMARY STREAM & RESEVOIR
-  SUPPLEMENTAL RESERVOIR ONLY

FINAL PROOF SURVEY  
UNDER

R-48517                      R-5891  
Application No. 48518    Permit No. 36402  
IN NAME OF

L. R. PETERS

Surveyed Sept. 6 1974, by *D. Dorby*