

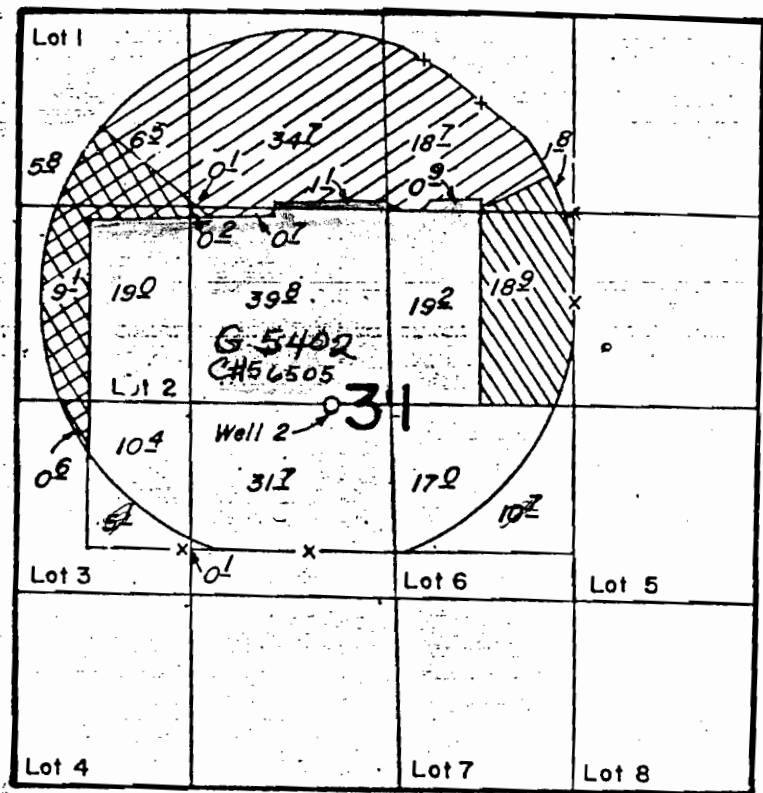



G-5402

48888 CD
56505
T5364

T.26S.,R.14E.,W.M.



-  G-9288
-  T-5363
-  G-11072

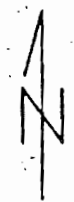

Well Loc: 2600' S, & 2900' W, from the NE corner Section 31

SCALE: 4" = 1 MILE

FINAL PROOF SURVEY UNDER

TRANSFER NOS. T-5363 & T-5364
 G-11072 G-10227
 Application No. G-9288. Permit No. G-8709.....
 IN NAME OF
MICHAEL W. MATTIS
 Surveyed July 27, 1983, by L. M. TOLL.....
 Oct. 12, 1984, by P. PAGTER