

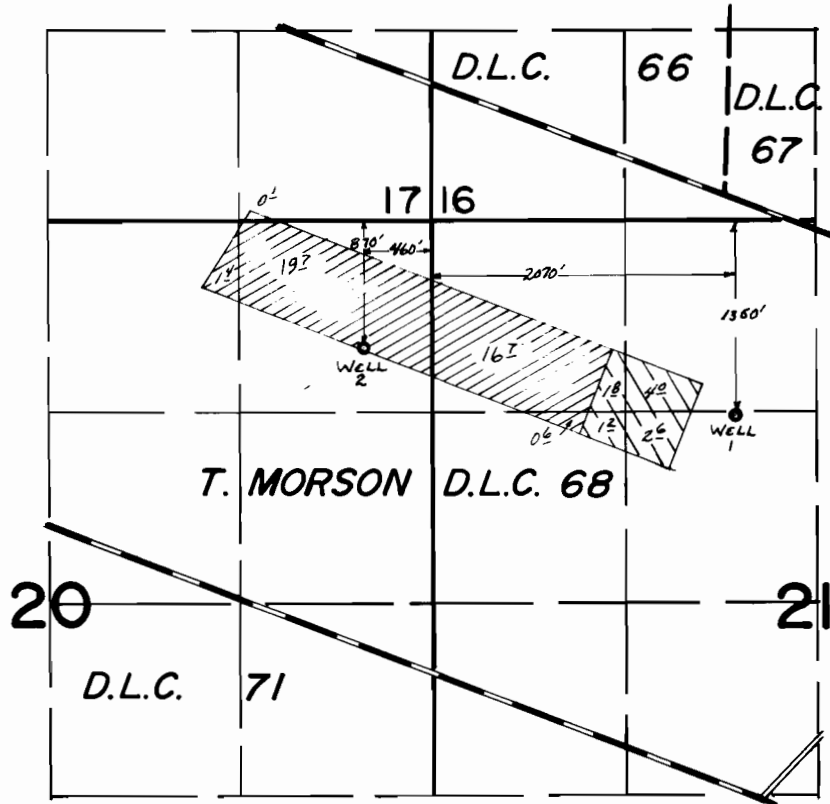

# T. 6S. R. 2W. W.M.



## FINAL PROOF SURVEY UNDER

Application No. G-7931 Permit No. G-7318  
 Application No. G-7932 Permit No. G-7319  
 IN NAME OF

 - 1/2R. FROM WELL 1  
 - 1/2R. FROM WELL 2

JERRY BARCHUS

Surveyed Oct. 3, 1979, by C.R. RODRIGUEZ