

T.1S.R.3E.W.M.

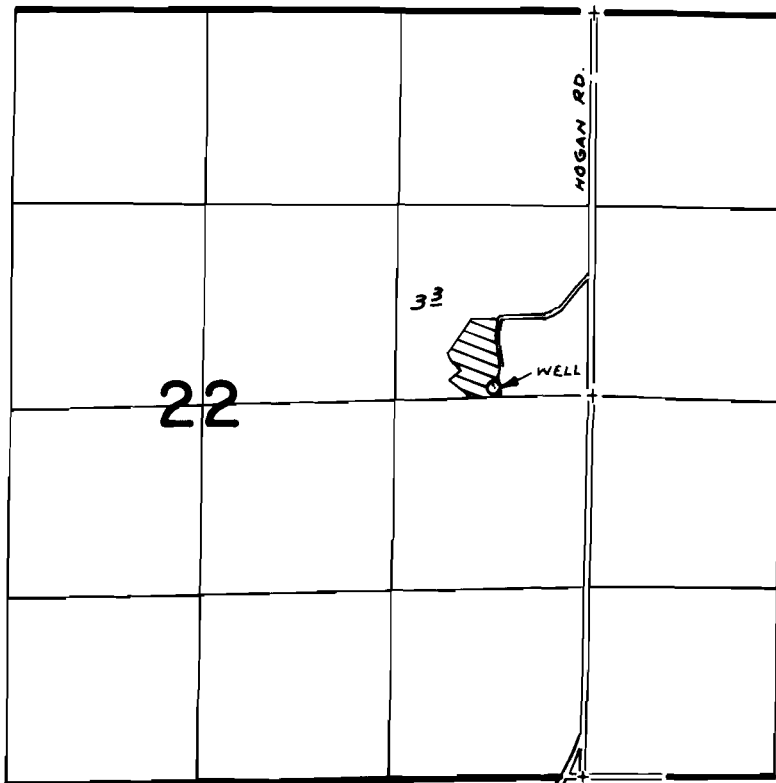

WELL LOC: 60' N. & 650' W. FROM E $\frac{1}{4}$ COR. SEC. 22

FINAL PROOF SURVEY
UNDER

Application No. ~~G-5232~~ Permit No. ~~G-5090~~.....
IN NAME OF

.....
Surveyed ~~DEC. 3,~~ 19.79, by ~~R. MUGKEN~~.....