

T.7S. R.2W, W.M.

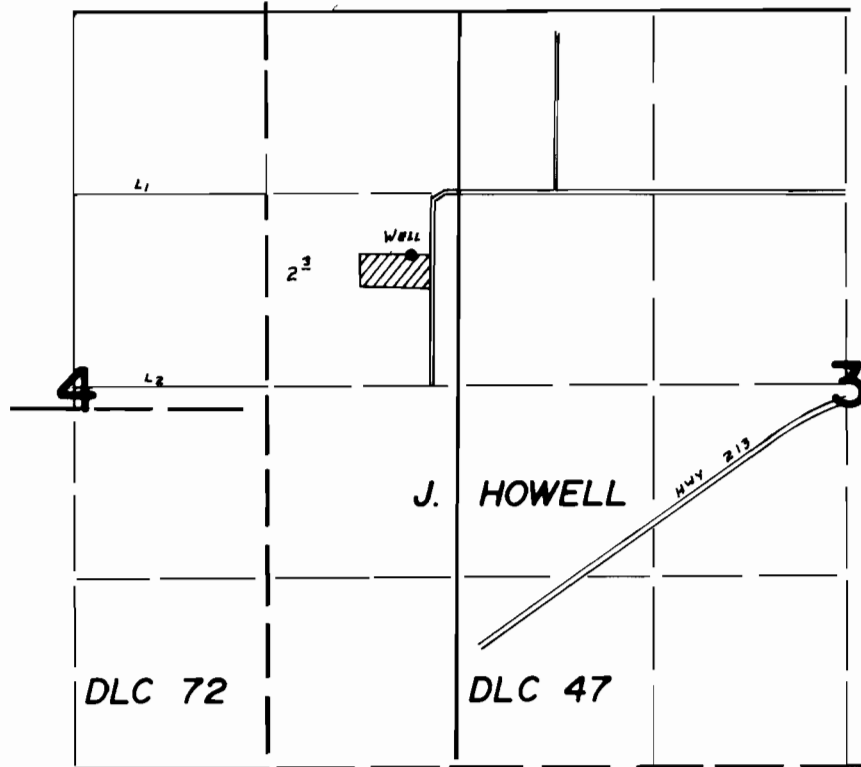

WELL LOC. 3520' N. & 980' E. FROM S.W. COR. DLC 47

FINAL PROOF SURVEY UNDER

Application No. G-6160... Permit No. G-5844.....
IN NAME OF

RICHARD & MARGARET JOHNSON

Surveyed MAY...17... 1979., by L.H. NUNN.....