

# T.36 S., R.3 W., W.M.

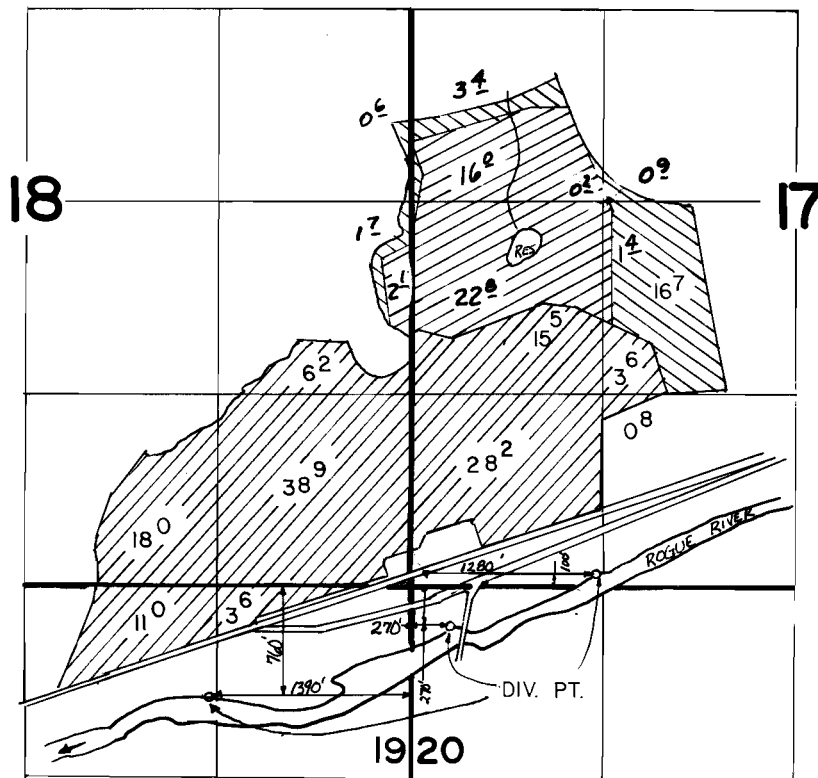

1" = 1320'

## FINAL PROOF SURVEY UNDER

Application No. 47103... 47104... Permit No. 35270... 35271...  
 IN NAME OF

.....**DEL RIO ORCHARDS**.....

Surveyed MARCH 30 1982, by .B.R..SUND.....