

T. 29S., R. 6W., W.M.

SEC. 15

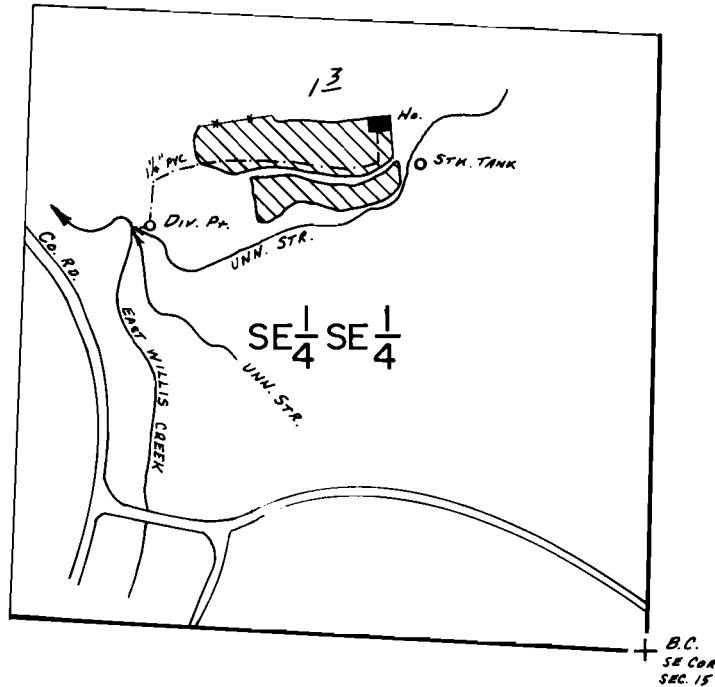

DIV. PT. LOC: 885'N. & 1025'W. FROM SE COR. SEC. 15

SCALE: 1" = 400'

FINAL PROOF SURVEY
UNDER

Application No. 49983.. Permit No. 37944.....
IN NAME OF

.....MR. & MRS. DAVID BERNARD.....

Surveyed APR. 3..... 19.79., by J.S. DONALDSON.

Doug G. 77-4-79
ZTS