

T. 37 S., R. 3 E., W. M.

SEC. 16

NW 1/4 SE 1/4

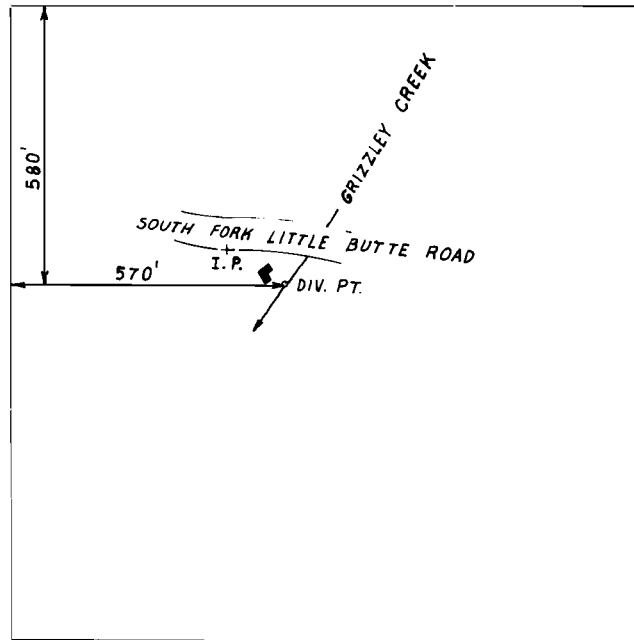

Scale: 1" = 400'

### FINAL PROOF SURVEY

UNDER

Application No. 52135... Permit No. 38063....  
IN NAME OF

.....ROBIN.....SULLIVAN.....

Surveyed JULY 29, 1982, by B. R. SUND.....