

T. 26 S., R. 3 W., W.M.

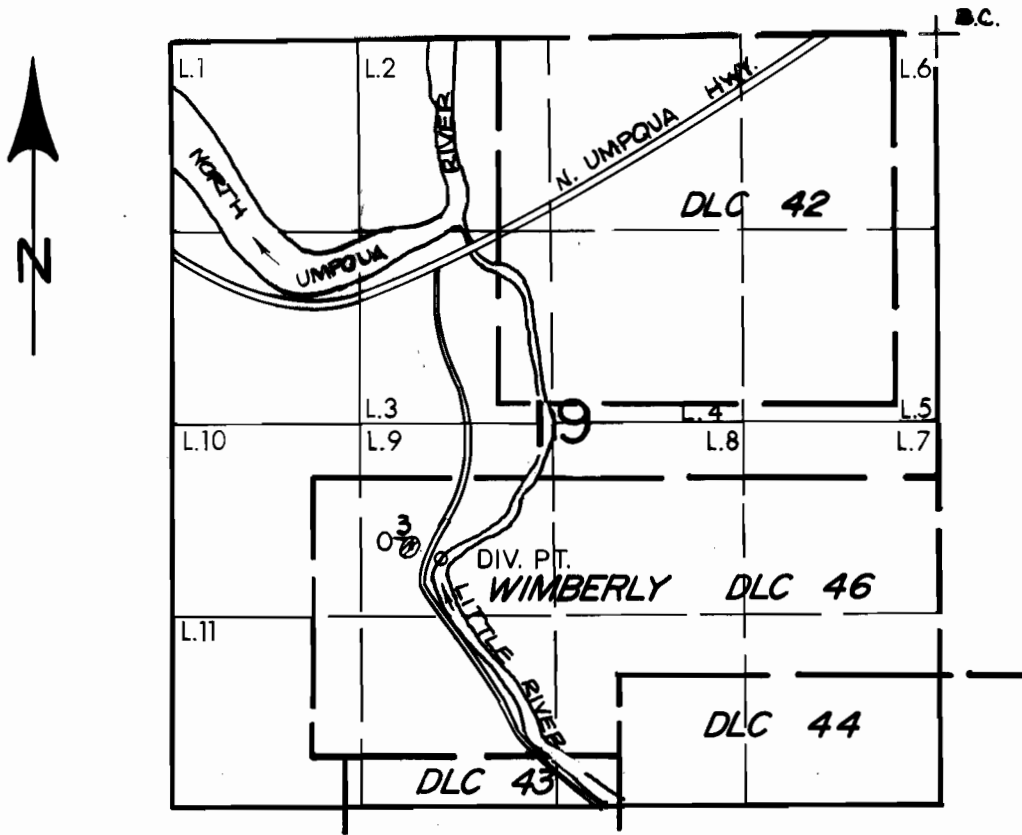

DIV. PT. IS LOCATED 3600' S. & 3425' W. FROM NE COR. SEC. 19

SCALE : 4" = 1 MILE

FINAL PROOF SURVEY UNDER

Application No.65301... Permit No.47685.....
IN NAME OF

.....NANCY STERN.....

Surveyed SEPT. 16, 19.86, by ...J.M. SCHMORDE.