

T.5S., R.1W., W.M.

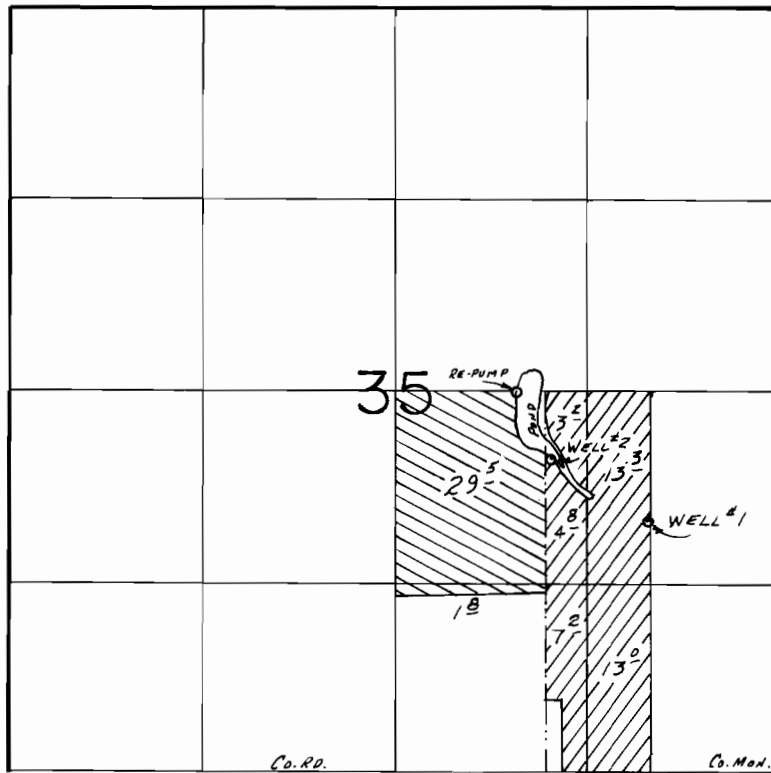

WELLS LOC.: #1- 1750 N. & 900 W., #2- 2170 N. & 1550 W., BOTH FROM SE COR. SEC. 35.

-  Well No. 1
-  Well No. 2

SCALE: 1" = 1320'

FINAL PROOF SURVEY UNDER

Application No. G-8448 Permit No. G-7662....
IN NAME OF

ESTATE OF LEONTY MENEYEV

Surveyed Mar. 26... 19.86, by T.M. WARREN....