

T. 40 & 41 S., R. 13 W., W.M.

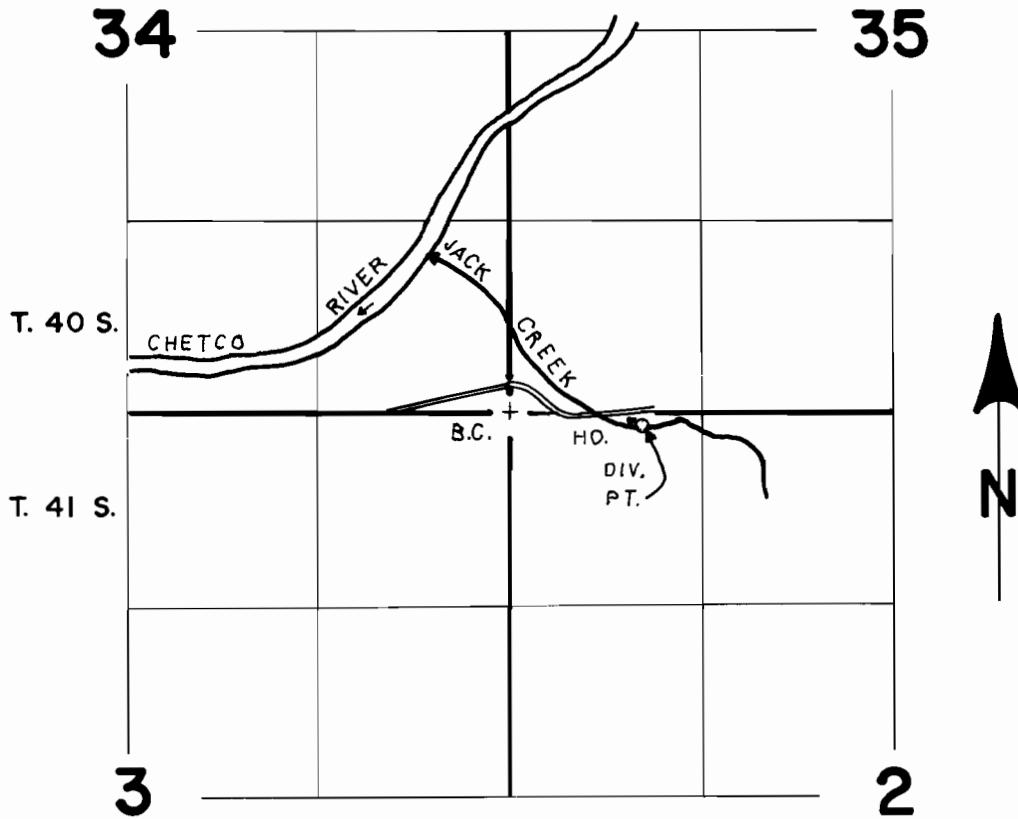

DIV. PT. LOCATED 60' S. & 910' E FROM NW COR. SEC. 2.

SCALE: 4" = 1 MILE

FINAL PROOF SURVEY UNDER

Application No. 60244 Permit No. 45307....
IN NAME OF

OREGON DEPARTMENT OF FISH AND WILDLIFE

Surveyed OCT. 11, 1985, by J. M. SCHMORDE