

# T. 26S., R. 12W., W.M.

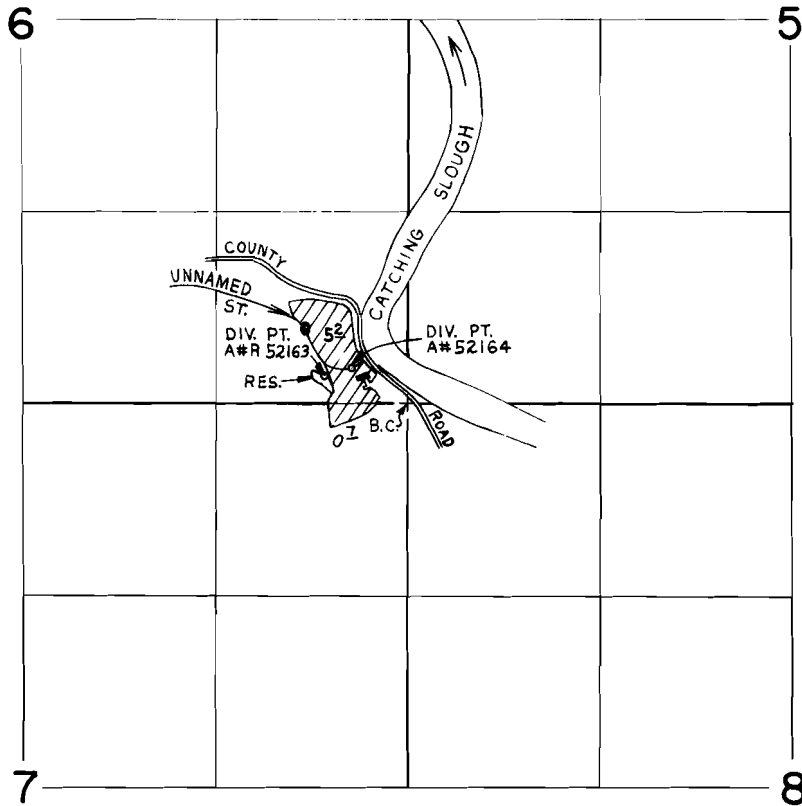

RESERVOIR LOCATED 190' N. & 585' W. FROM S.E. COR. SEC. 6  
DIV. PT. UNNAMED STREAM 245' N. & 385' W. FROM S.E. COR. SEC. 6

SCALE: 4" = 1 mile

## FINAL PROOF SURVEY

UNDER

52164                      39283  
Application No. R-52163    Permit No. R-6291  
IN NAME OF

CALVIN W. HECKARD

Surveyed OCT. 27, 1983, by L. CASHION