

T.13S. R.1W. W.M.

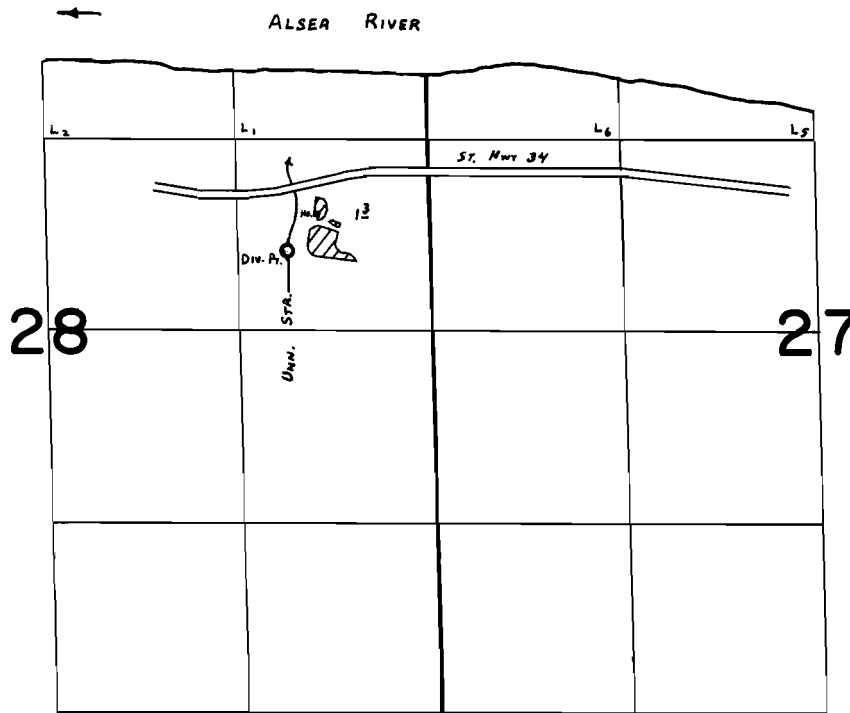

Div. Pt. Loc: 760' S. & 980' W. fr. S.E. Cor. Lot 1 Sec. 28.

FINAL PROOF SURVEY UNDER

Application No. 50509 Permit No. 37782
IN NAME OF

WILFORD CLAYBURN & MYRTLE IDA THOMPSON

Surveyed June 15, 1979, by C. L. HUGHES