

T. 38 S., R. 5 W., W.M.

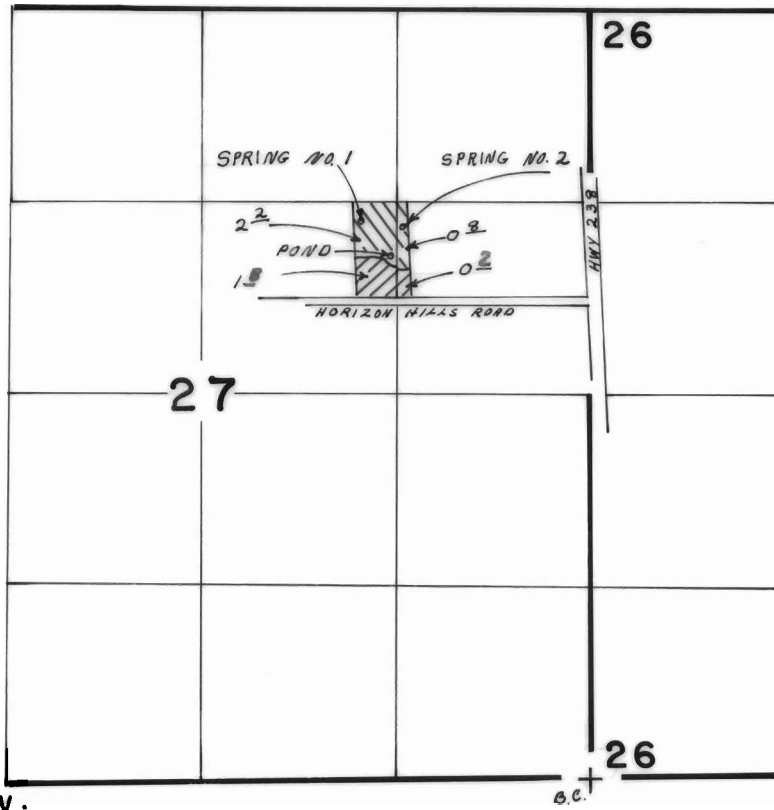

DIVERSIONS:

1 = 3830' N., 1560' W.;

2 = 3800' N., 1250' W.;

from SE cor. Sec. 27

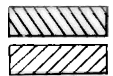

Primary

Supplemental

Scale: 1" = 1320'

FINAL PROOF SURVEY

UNDER

Application No. **58292**, Permit No. **43976**.
IN NAME OF

DANIEL A. & MYRTLE BIGHAUS

Surveyed **AUG. 29, 1985.**, by **B. S. JAMES**....