

T.15S.,R.4W.,WM.

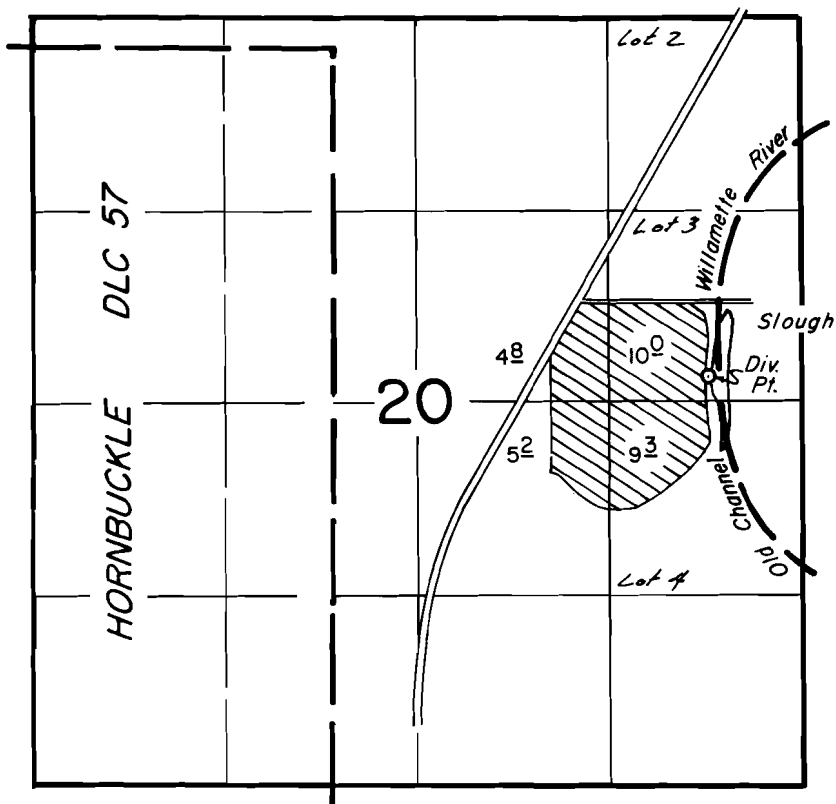

Diversion Point Located: 170' N. & 640' W. from the E. 1/4 Cor. Sec.20

**FINAL PROOF SURVEY**  
UNDER

Application No. 58707 Permit No. 44394  
IN NAME OF

NIXON FARM INC.

Surveyed MAY 8, 1980, by [Signature]