

T.1&2 S., R.2&3 W., W.M.

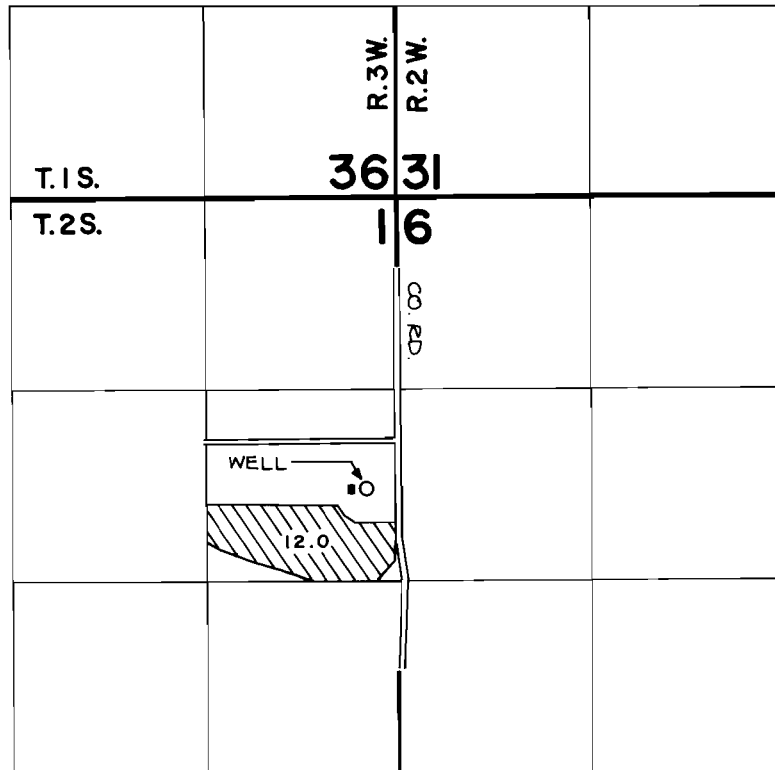

WELL IS LOCATED S. 5.5° W. 2030' FROM THE N.E. CORNER OF SECTION 1.

FINAL PROOF SURVEY UNDER

Application No. G-6947 Permit No. G-6462
IN NAME OF

CHARLES J. & VIOLA J. LEIFERMAN

Surveyed NOV. 14 1983, by L. TOLL