

G-9051
36308

T. 6N., R. 35E., W.M.

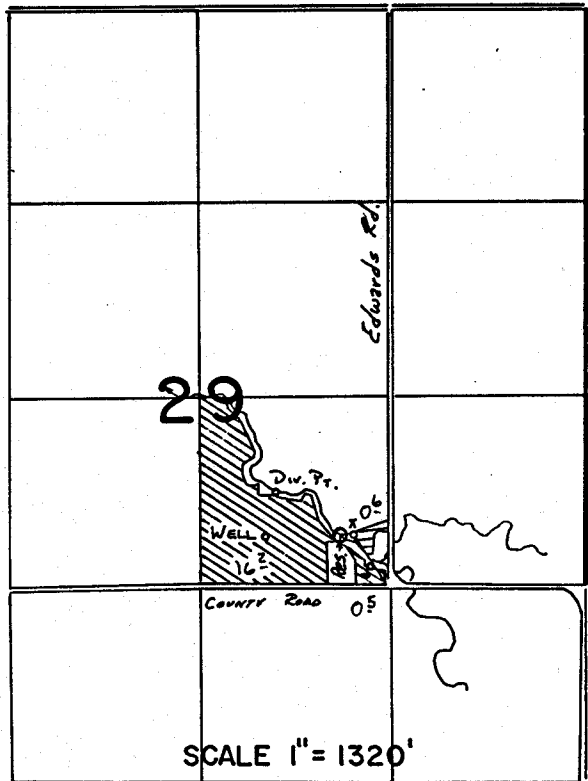
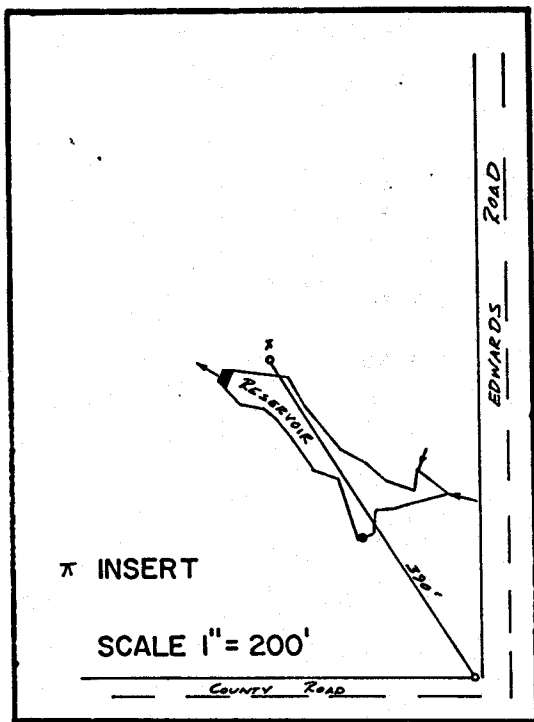

DIV. PT. LOCATED - 640'S. & 520'E. FROM CENTER COR. SEC 29

WELL LOCATED - 950'S. & 450'E FROM CENTER COR. SEC 29

RESERVOIR - 940'S. & 970'E. FROM CENTER COR. SEC 29



PRIMARY
PER. G-9051



PRM. PER. 45369
SUPPL. PER. G-9051

FINAL PROOF SURVEY

UNDER

58681

45369

R-58682

R-8212

Application No. G-9761.. Permit No. G-9051.....

IN NAME OF

S. A. GOUTHER

Surveyed 4.25..... 1984, by V.L. Church.....

NZ-5MM-71
PTS-1984-PB

V.L.C.