

T. 6N., R. 35E., W. M.

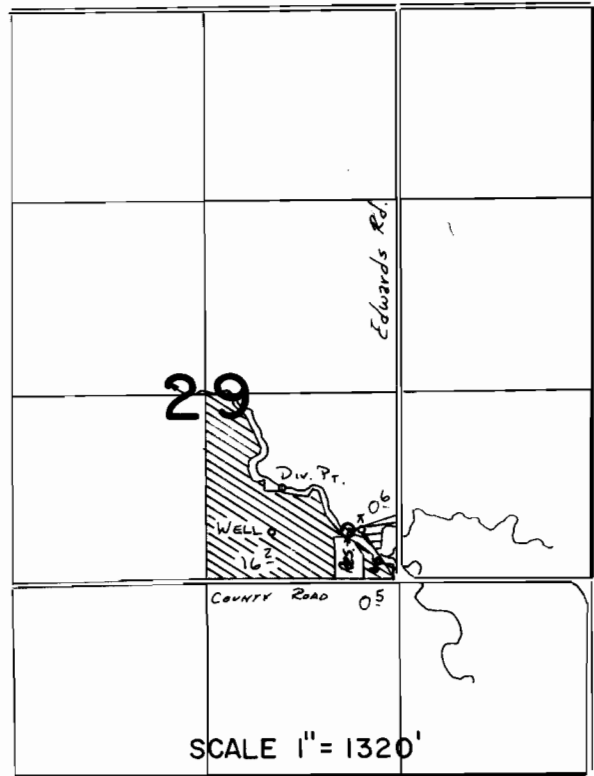

DIV. PT. LOCATED - 640'S. & 520'E. FROM CENTER COR. SEC 29
 WELL LOCATED - 950'S. & 450'E FROM CENTER COR. SEC 29
 RESERVOIR - 940'S. & 970'E. FROM CENTER COR. SEC 29

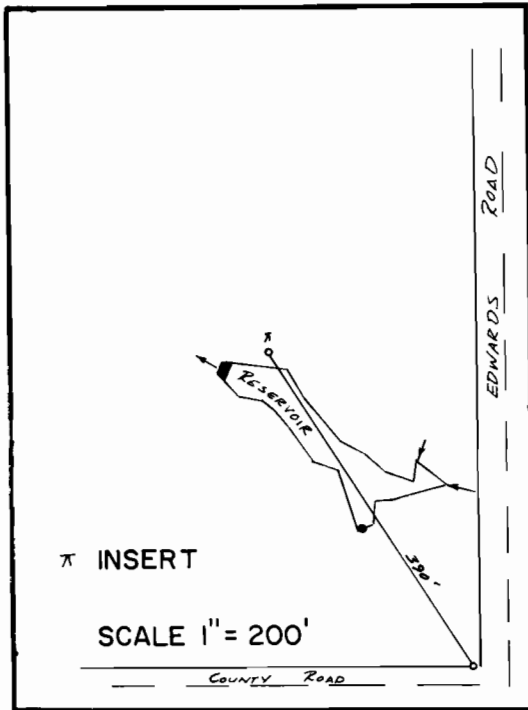

PRIMARY
 PER. G-9051



PRI. PER. 45369
 SUPPL. PER G-9051

FINAL PROOF SURVEY
 UNDER

58681 45369
 R-58682 R-8212
 Application No. G-9761 Permit No. G-9051.....
 IN NAME OF

S. A. GOUTHIER

Surveyed 4-25..... 1984., by V.L. Church.....