

T. 4S., R. 4W., W.M.

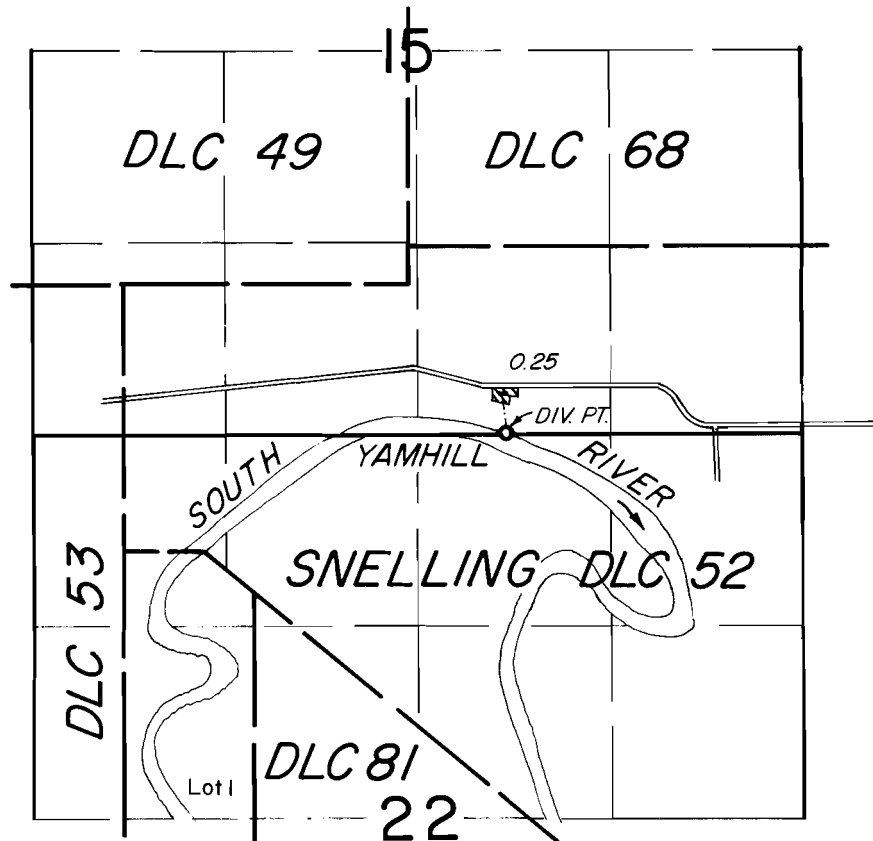

DIV. PT. LOC.: 20' N. & 2030' W. FROM SE COR. SEC. 15.

FINAL PROOF SURVEY
UNDER

Application No. 50518. Permit No. 38146.....
IN NAME OF

John V. & Myrtle L. Young.....

Surveyed MAY 8, 1979, by *dl Brown*.....