

T.27S.,R.6W.,W.M.

Section 6

SE 1/4 SW 1/4

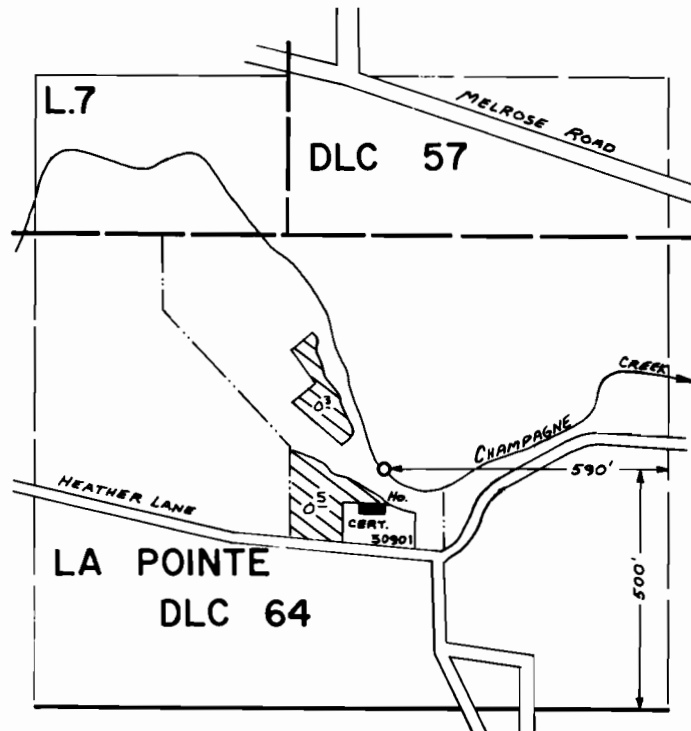

SCALE: 1" = 400'

FINAL PROOF SURVEY

UNDER

Application No. 50803. Permit No. 38362.....
IN NAME OF

.....JERRY GAUSNELL.....

Surveyed June 22, 1982., by L.M. TOLL.....