

T.17S.,R.6W.,W.M.

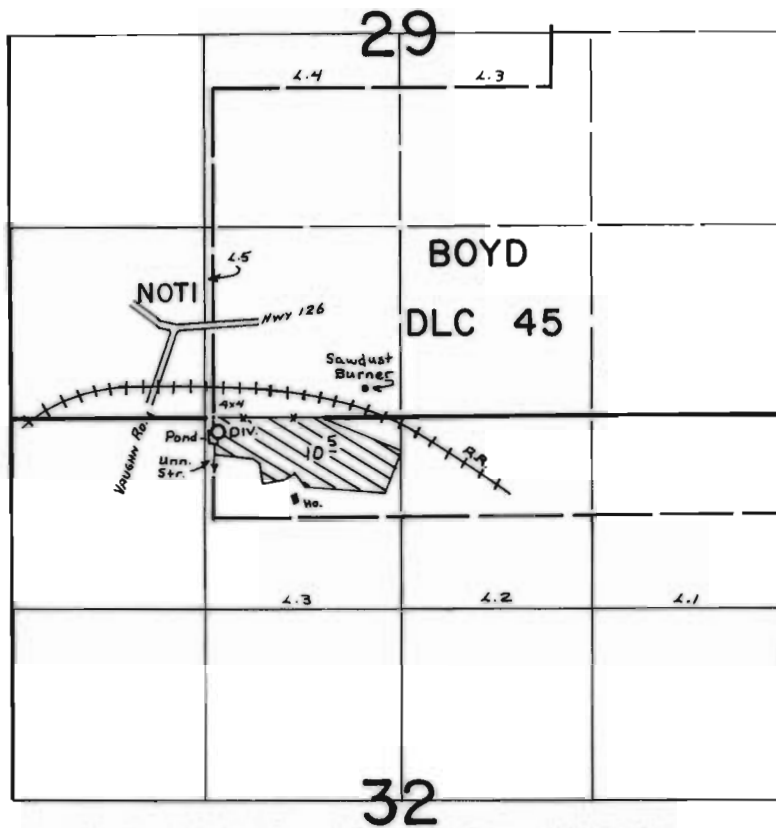

DIV. Pt. Loc: 100 ft S and 20 ft E from N'NE Cor.
Lot 3 (NE⁴NW⁴) Sec 32

FINAL PROOF SURVEY
UNDER

Application No. 51007... Permit No. 38500.....
IN NAME OF

.....**ELDON E. HEATH**.....

Surveyed May...4... 1982., by J. M. TOLL.....