

T. 5 S., R. 7 W., WM.

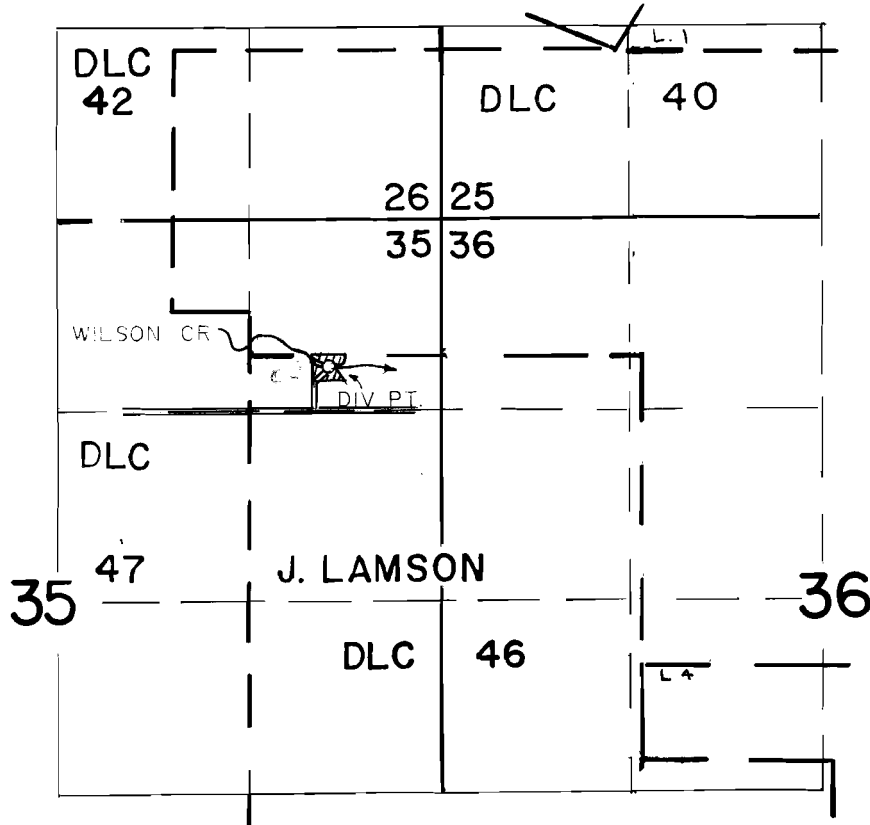

DIV. PT. LOC. 80' S. & 550' E. OF NW COR. DLC 46

**FINAL PROOF SURVEY**  
UNDER

Application No. 53102 Permit No. 38586

IN NAME OF

MARIAN L. CANNON

Surveyed NOV 5 1984, by P. PAGTER