

T. 2N., R. 5W., W.M.

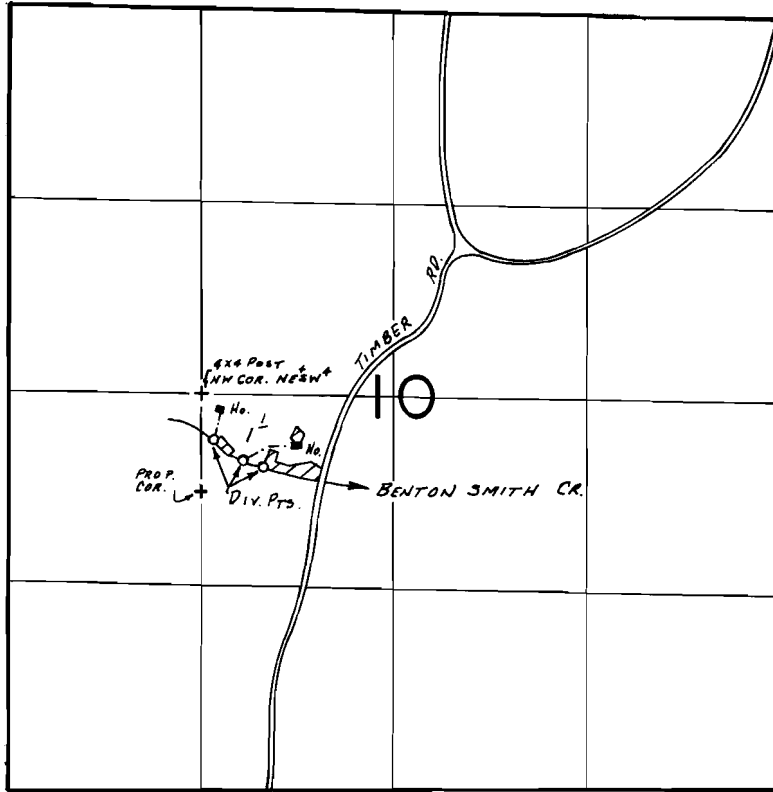

DIV. PTS. LOC. 330'S.  $\frac{1}{2}$  80'E., 450'S.  $\frac{1}{2}$  280'E., 500'S.  $\frac{1}{2}$  420'E., ALL FROM THE NW COR. NE SW  $\frac{1}{4}$  SEC. 10

**FINAL PROOF SURVEY**  
UNDER

Application No. 53130..... Permit No. 38607.....  
IN NAME OF

JAY H. WADE

Surveyed JULY 16... 1980, by R.G. MUCKEN.....