

T.21S. R.4W. W.M.

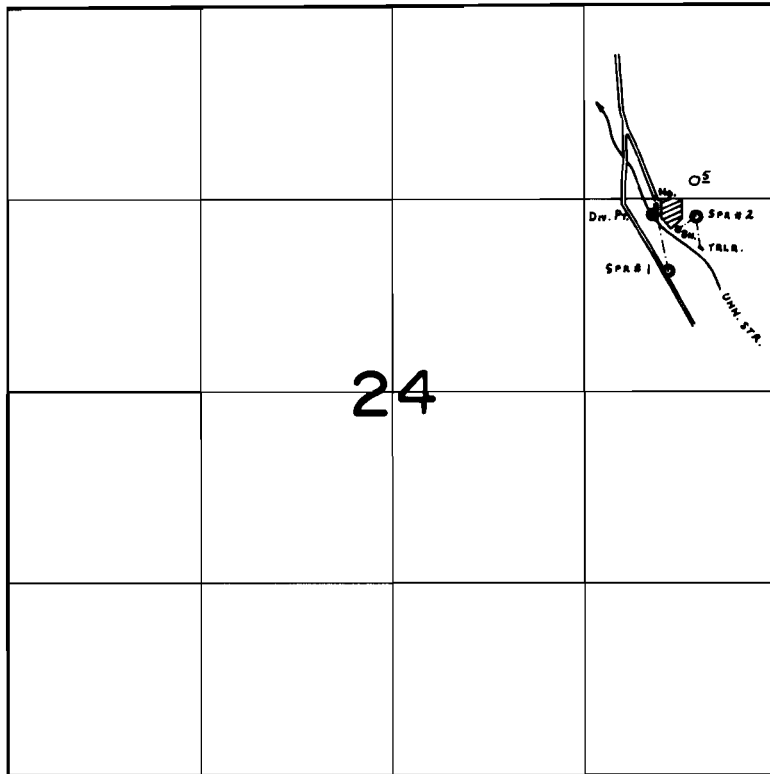

Div. Pt. Loc: 1440'S. & 850'W. }
SPR. Loc: #1-1830'S. & 740'W. } ALL FROM N.E. COR. SEC. 24.
#2-1460'S. & 550'W. }

FINAL PROOF SURVEY
UNDER

Application No. 56413 Permit No. 42838.....
IN NAME OF

GEORGE LANDON OLSON.....

Surveyed June 18, 1980, by C.L. Hughes.....