

T. 6 S., R. 6 & 7 W., W.M.

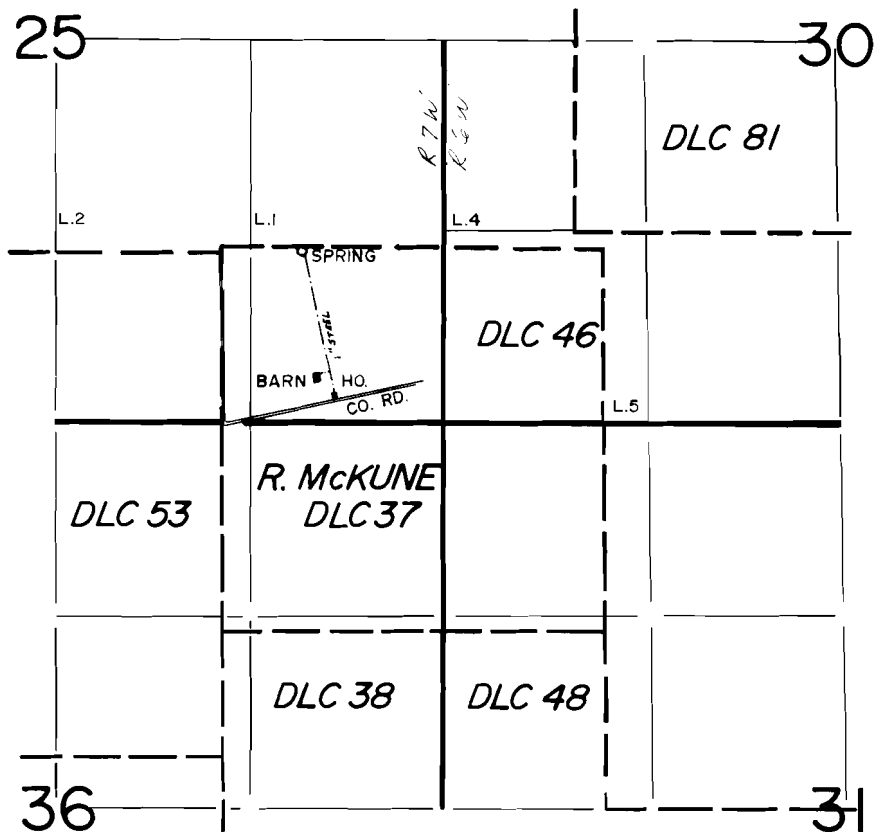

SPRING LOCATED 30' S. & 550' E. FROM NW CORNER R. McKUNE DLC 37

FINAL PROOF SURVEY
UNDER

Application No. 57201... Permit No. 42993.....
IN NAME OF

.....JAMES HENRY HARTLE.....

Surveyed ...MAY...31... 19.79., by R.G.MUCKEN.....