

T.13S. R.5W. W.M.

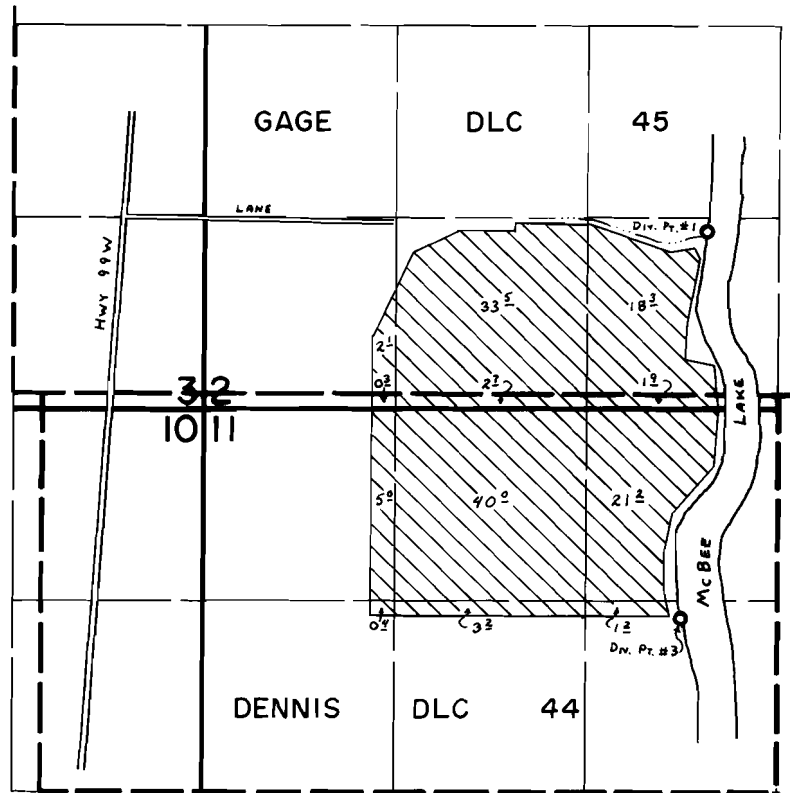

Div. Pts. Loc: #1 - 1120' N. & 490' W. fr. N.E. Cor. DLC 44.
 #3 - 1200' N. & 660' W. fr. S.E. Cor. DLC 44.

FINAL PROOF SURVEY UNDER

Application No. 55048. Permit No. 41287.....
 IN NAME OF

VENELL FARMS, INC.

Surveyed May 28, 1980, by C. L. Hughes.....