

T.19S., R.12W., W. M.

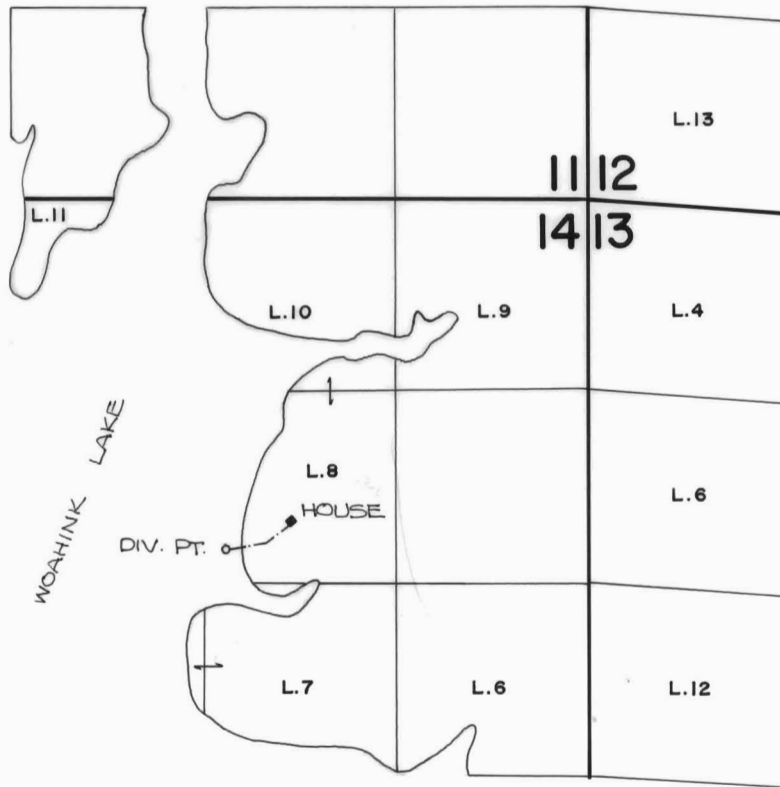

DIV. PT. LOCATION: 190 FT. N. AND 2500 FT. W. FROM THE E. 1/4 CORNER OF SECTION 14.

FINAL PROOF SURVEY UNDER



Application No. 59417 Permit No. 44773
IN NAME OF

SCALE: 4" = 1 MILE

EVERETT & GENEVA HANSON

Surveyed JULY 16, 1984, by P. Paster