

T.5S., R.6W., W.M.

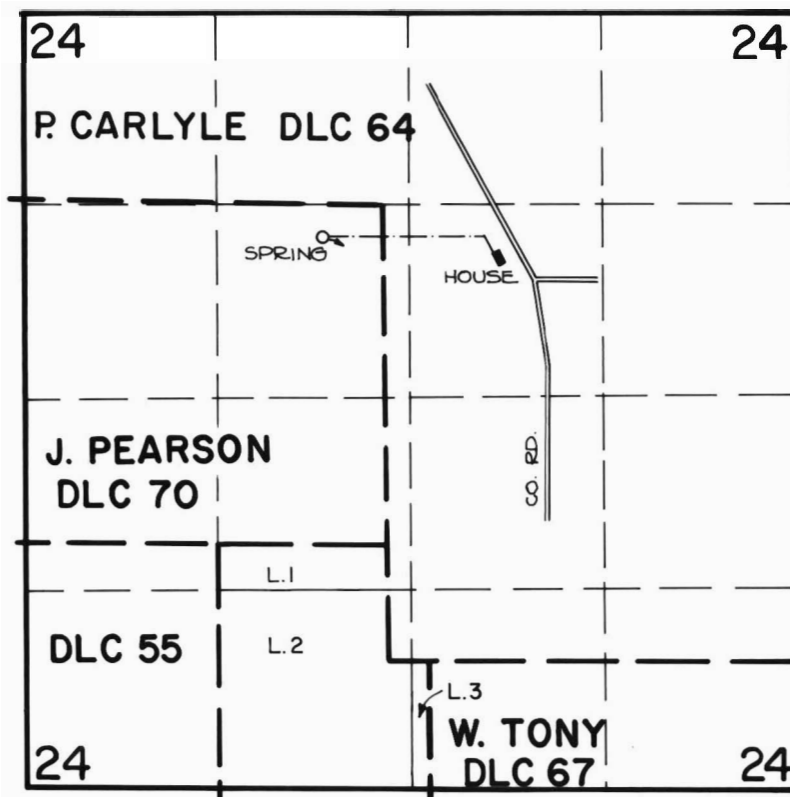

THE SPRING IS LOCATED 1540 FT. S. AND 600 FT. W.
FROM THE N1/4 CORNER OF SECTION 24.

FINAL PROOF SURVEY
UNDER

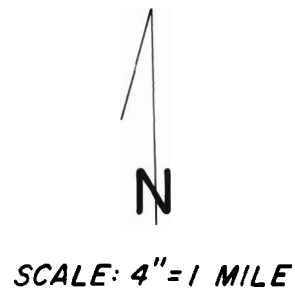

Application No. 60538. Permit No. 45291.....
IN NAME OF

A. W. DAVIS.....

Surveyed NOV......1984, by P. Patten.....