

T. 29S., R. 5W., W.M.

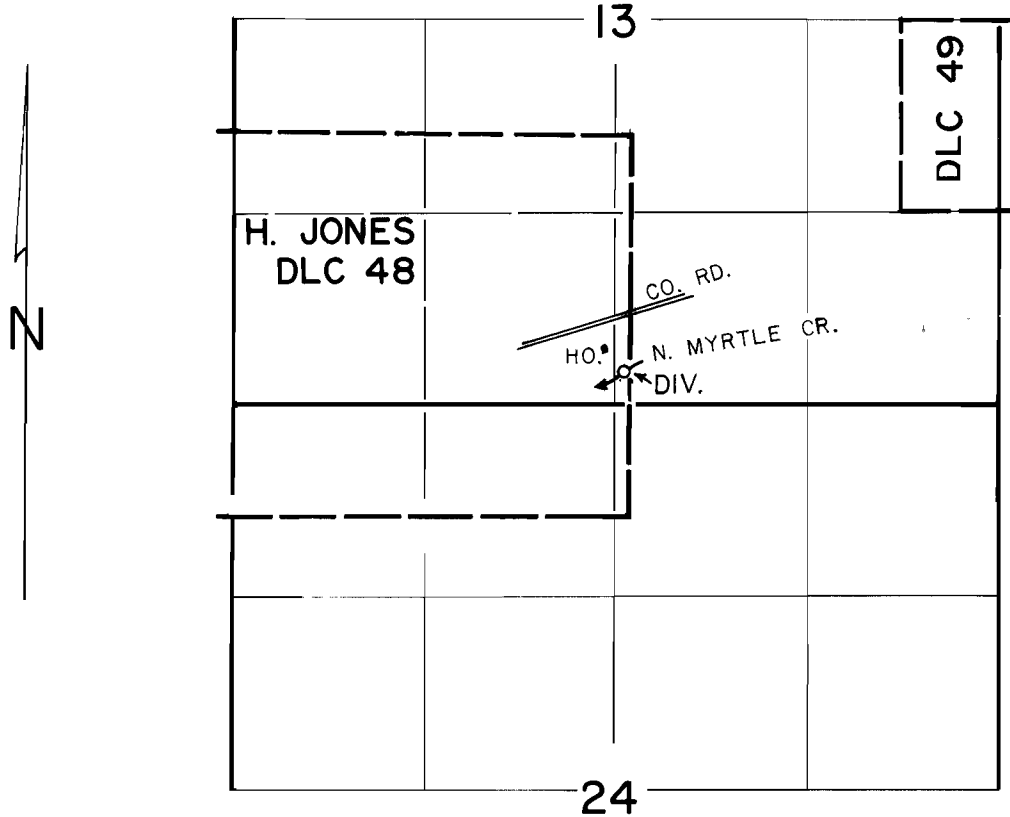

DIV. LOCATED 210' N. & 60' E. OF S. 1/4 COR. SEC. 13.

SCALE: 4" = 1 mile

FINAL PROOF SURVEY
UNDER

Application No. 64412. Permit No. 47177.....
IN NAME OF

.....EDWIN L. KUNTZ.....

Surveyed MAY 14, 1984, by D. CLARK.....