

WEST 1/4 COR.
5327105, R3E, W4E.
780' EAST

715' SOUTH

MCKENZIE HIGHWAY

Application No. 63328
Permit No. 47274

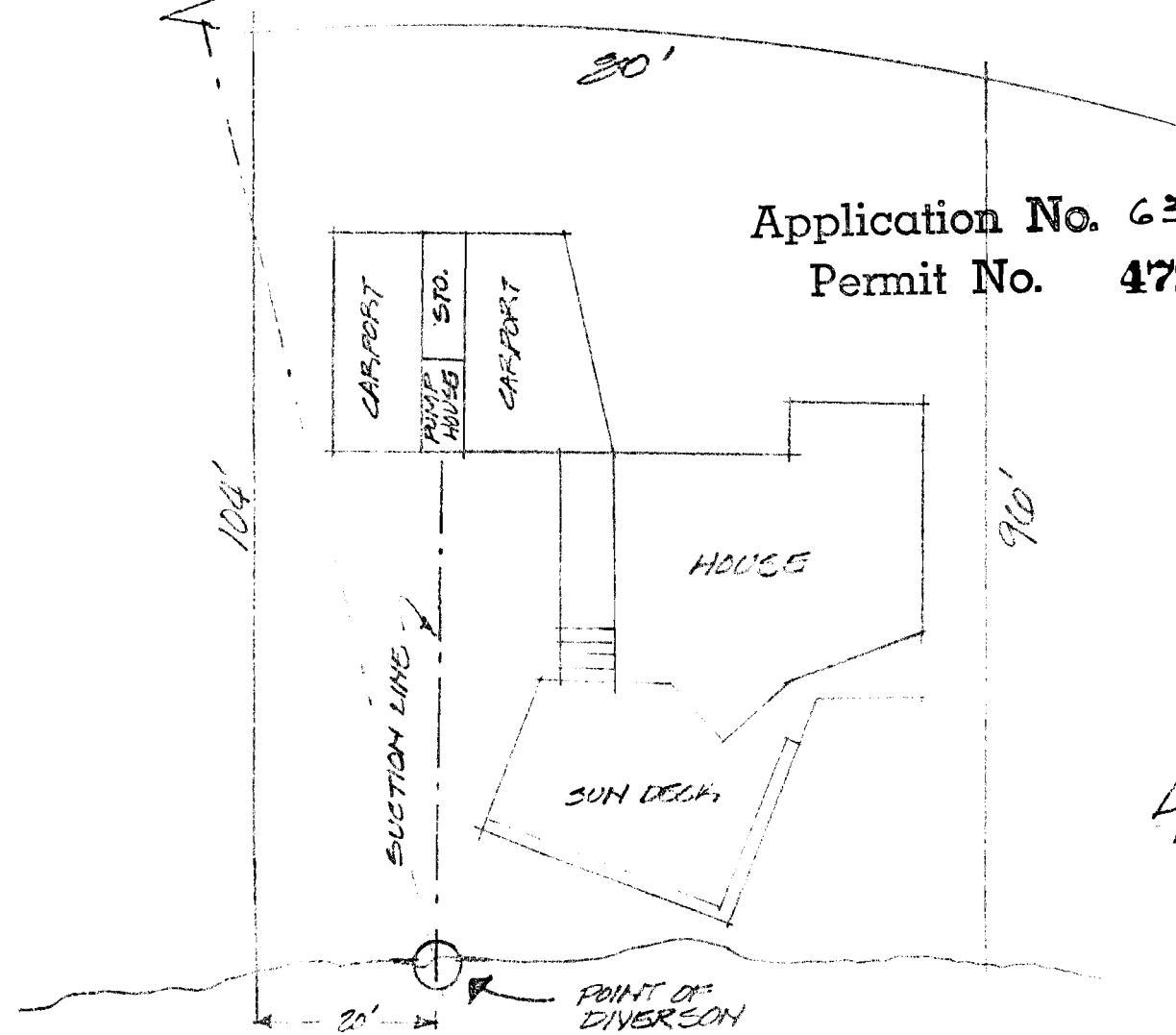

NORTH
NO SCALE

RECEIVED

DEC 28 1982

WATER RESOURCES DIV.
SALEM, OREGON

ED KASZTAN
4125 MCKENZIE HWY.

"EXHIBIT A"