

T.1S.R.8W.W.M.

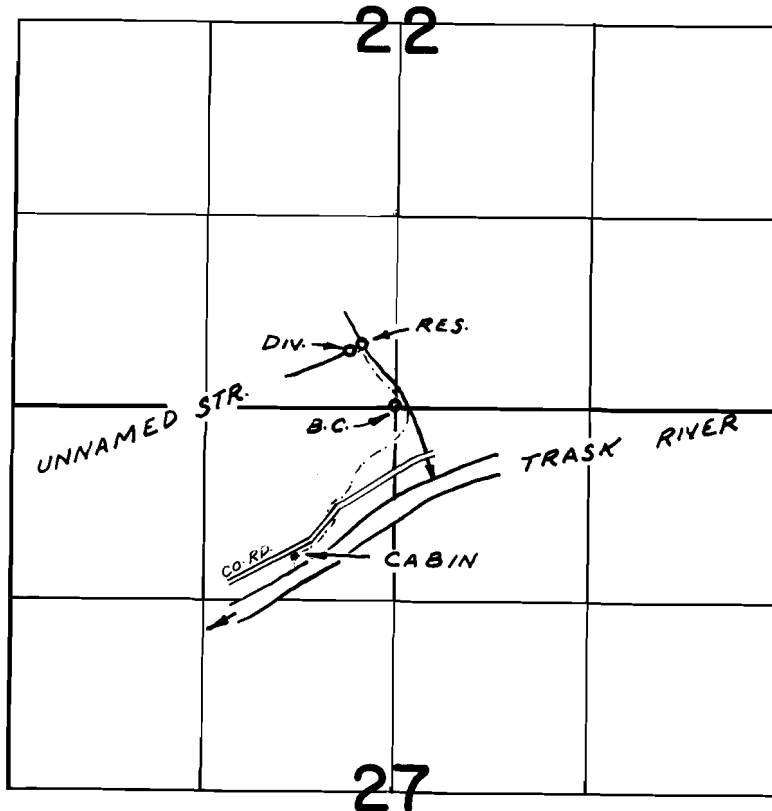

DIV. PT. LOC: 380' N. & 330' W. FROM S $\frac{1}{2}$ COR. SEC. 22

FINAL PROOF SURVEY UNDER

Application No. 55347 Permit No. 41794.....
IN NAME OF

MR. & MRS. STEPHEN M. HAYES

Surveyed FEB. 13, 1980, by R.G. MUCKEN