

T.13S., R.1E., W.M.

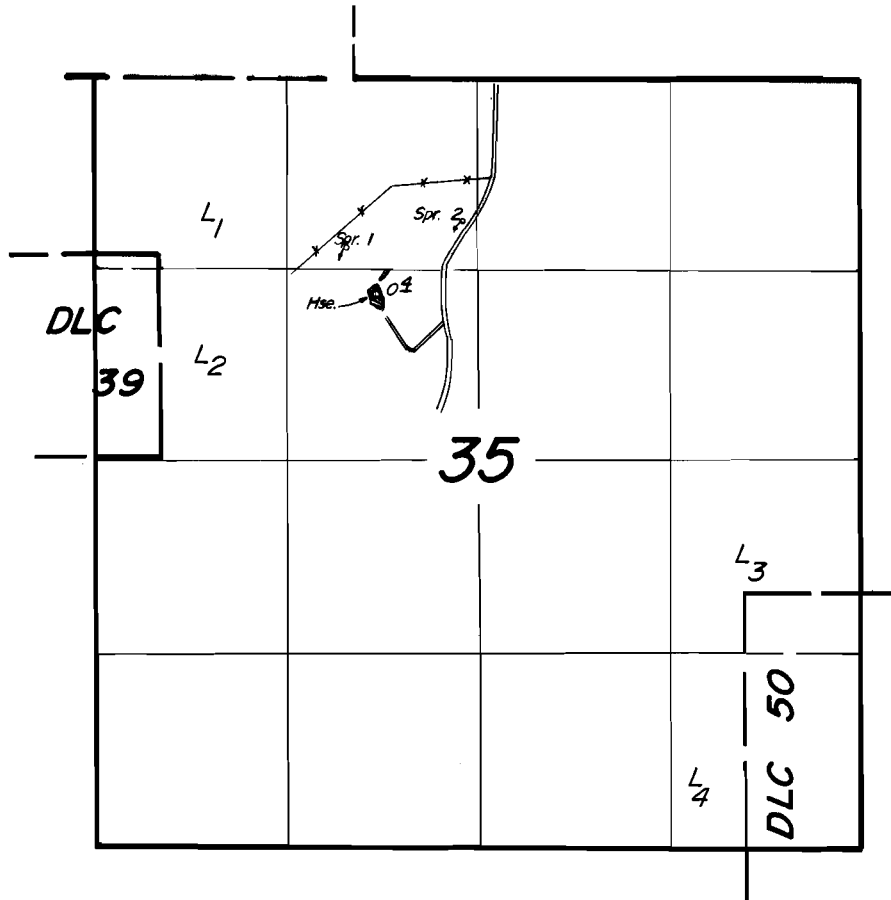

Spring 1 Loc.: 1160' S. & 910' W.

Spring 2 Loc.: 960' S. & 100' W., both from N 1/4 Cor. Sec. 35.

Scale: 1" = 1320'

**FINAL PROOF SURVEY**  
UNDER

Application No. 63693... Permit No. 47129.....

IN NAME OF

**JERRY ROBERT & BARBARA JANE STEVENS**

Surveyed JUNE 14, 1984, by L. TOLL.....