

T. 6S., R. 2W., W.M.

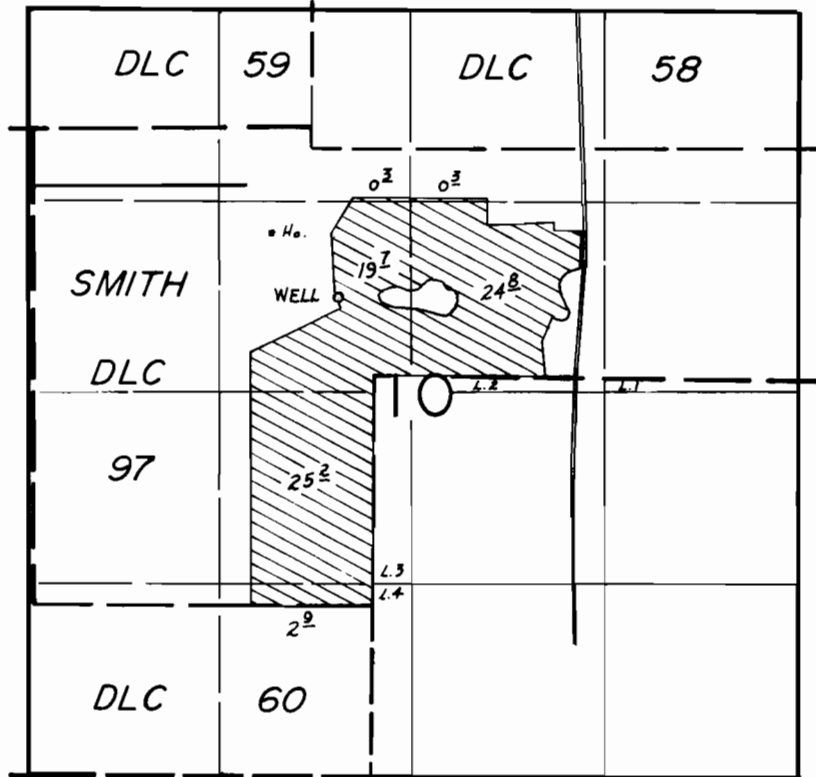

WELL LOC. 2120' N. & 230' W. FROM MOST SOUTHERLY SE CORNER OF SMITH DLC 97.

**FINAL PROOF SURVEY**  
UNDER

Application No. ~~9-6757~~..... Permit No. ~~9-6277~~.....  
IN NAME OF

.....**GEORGE J. HAUPTMAN**.....

Surveyed MAY 12..... 1980., by B.W. BISHOP.....