

T. 4 S. R. 14 E. W. M.

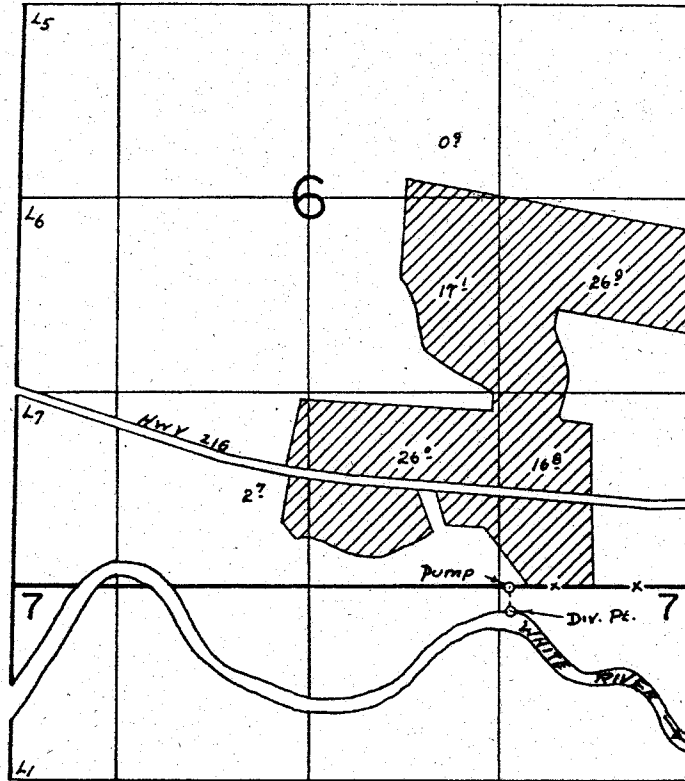

Div. Pt. Loc. 150' S & 1230' W. FROM THE NE COR. SEC. 7

FINAL PROOF SURVEY
UNDER

Application No. 48060. Permit No. 36038.
IN NAME OF

KENNETH C. & GRACE M. WEBB

Surveyed Oct. 31, 1984, by T. J. Paul.....