

G-6890
57137

T. 1 N. R. 32 E. W. M.

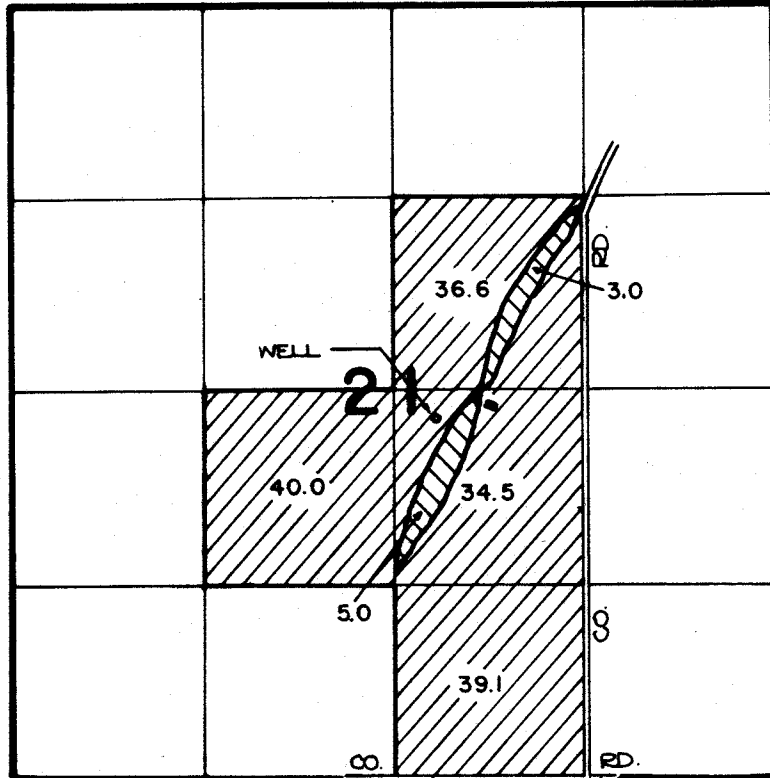

THE WELL IS LOCATED 2510' N. AND 2300' W.
FROM THE S.E. CORNER OF SECTION 21.

 PRIMARY IRRIGATION
 SUPPLEMENTAL IRRIGATION
FINAL PROOF SURVEY
UNDER

Application No. G-7327 Permit No. G-6890...
IN NAME OF

ROBERT N. & SUE VANDERPOOL

Surveyed MAY 18, 1983, by X. CHURCH.....