

RECEIVED

MAR 23 1978

WATER RESOURCES DEPT
SALEM, OREGON

T.15S., R.10E., W.M.

Application No. G 8548
Permit No. G 8148

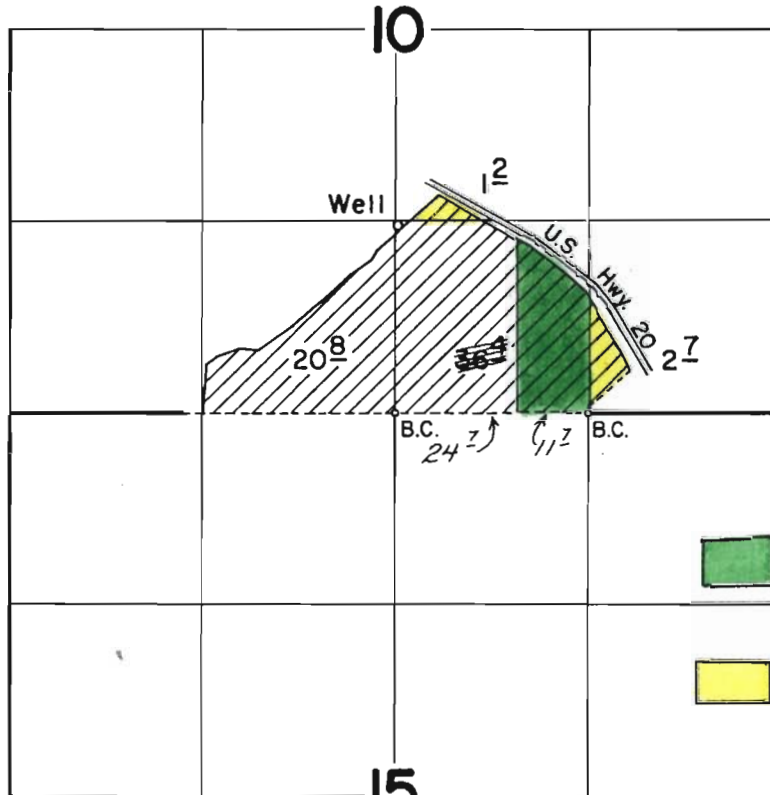

WELL LOC: 1290' N & 20' E FROM S 1/4 COR. SEC. 10

FINAL PROOF SURVEY
UNDER

Application No. G-3489 Permit No. G-3095
IN NAME OF

LLOYD F. BROGAN

Surveyed Oct. 30 1975, by D. Norby