

T.3N.R.1&2W.W.M.

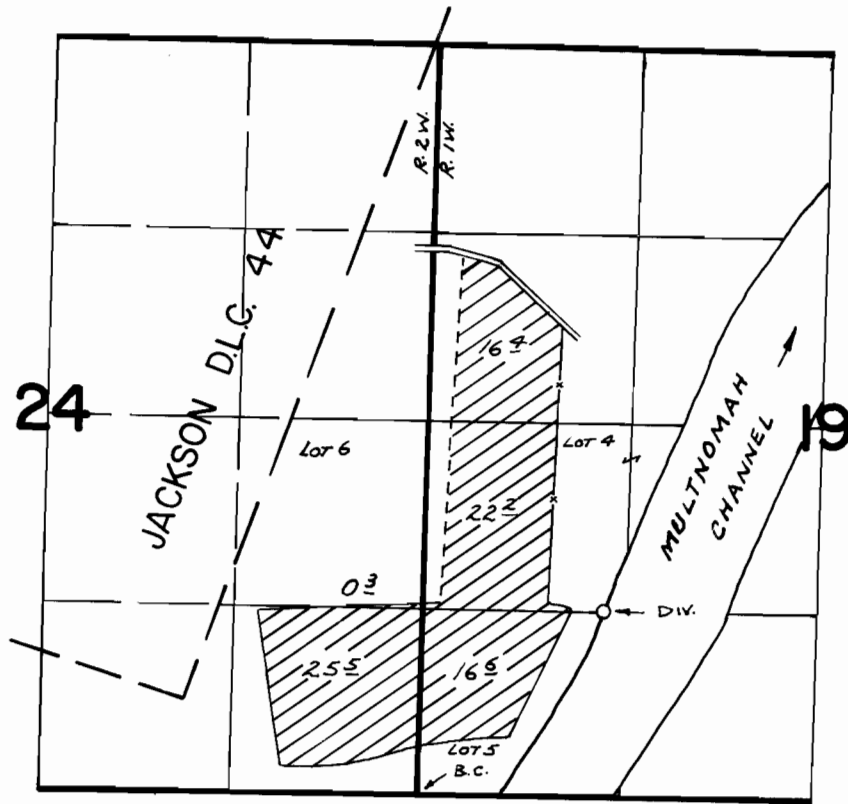

DIV. LOC: 1280' N. & 1240' E. FROM S.W. COR. SEC. 19

FINAL PROOF SURVEY UNDER

Application No. 47907.. Permit No. 35781.....
IN NAME OF

.....JAMES ERNEST.....

Surveyed APR. 7... 1980., by R. MUCKEN..