

T. 7S., R. 39E., W.M.

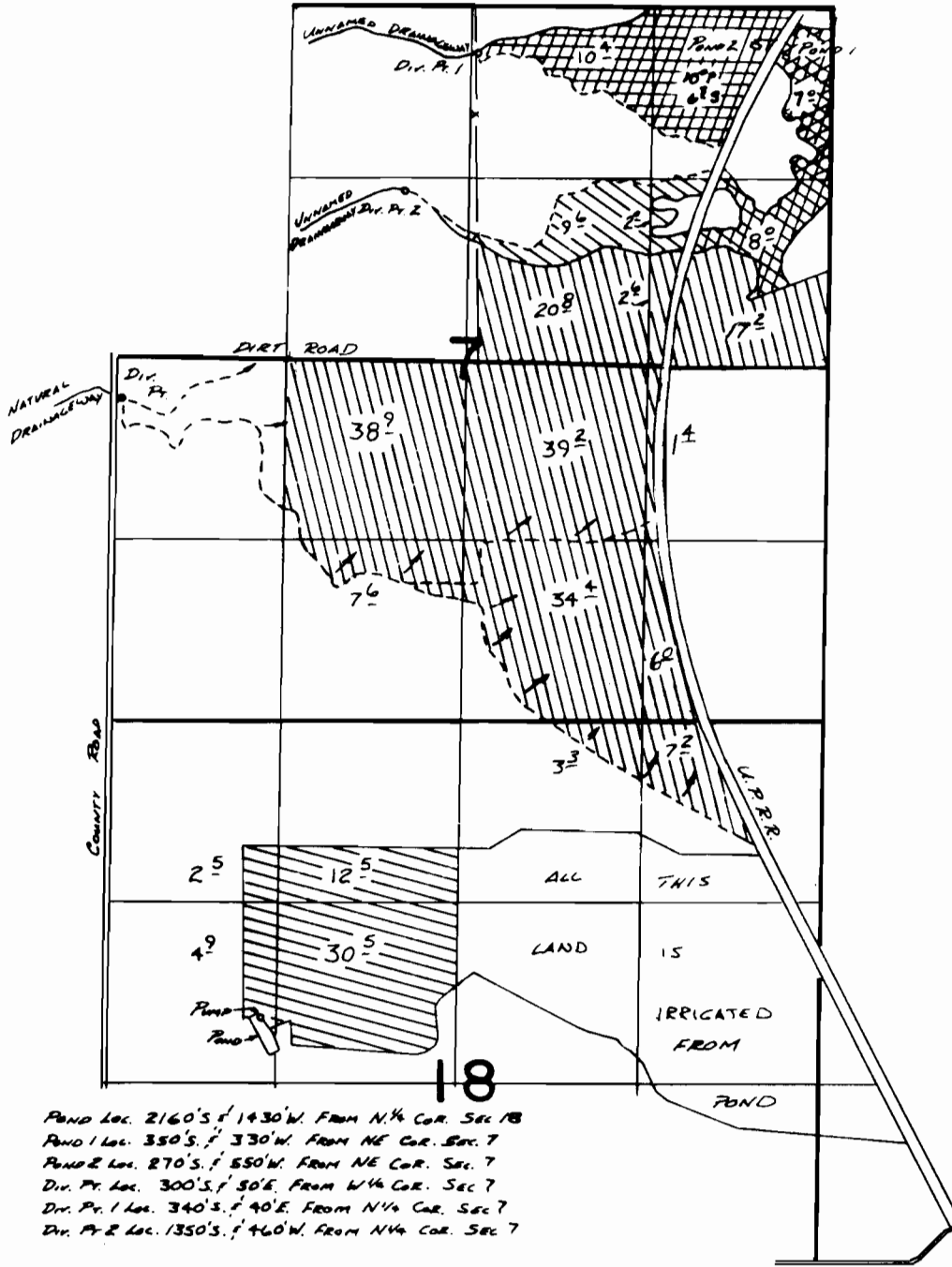

POND Loc. 2160'S. f 1430'W. FROM N $\frac{1}{4}$ COR. SEC 18
 POND 1 Loc. 350'S. f 330'W. FROM NE COR. SEC. 7
 POND 2 Loc. 270'S. f 550'W. FROM NE COR. SEC. 7
 Div. Pr. Loc. 300'S. f 50'E. FROM W $\frac{1}{4}$ COR. SEC 7
 Div. Pr. 1 Loc. 340'S. f 40'E. FROM N $\frac{1}{4}$ COR. SEC 7
 Div. Pr. 2 Loc. 1350'S. f 460'W. FROM N $\frac{1}{4}$ COR. SEC 7

FINAL PROOF SURVEY

UNDER







49310 36970
 51700 38977
 G-7191 G-6622
 G-6316 G-5932

Application No. Permit No.

IN NAME OF

..... PETER W. SCHOENINGH

Surveyed OCT. 25, 1977, by R. F. BARKIN.....
 REVISITED MAY 26, 1982, V. L. CHURCH & B. ESTES

-  PER. G-6622
-  Div. Pr. 1 PER. 38977
-  Div. Pr. 2
-  POND 1 PER. G-5932
-  POND 2
-  PER. 36970