

T.6S. R.1W., W.M.

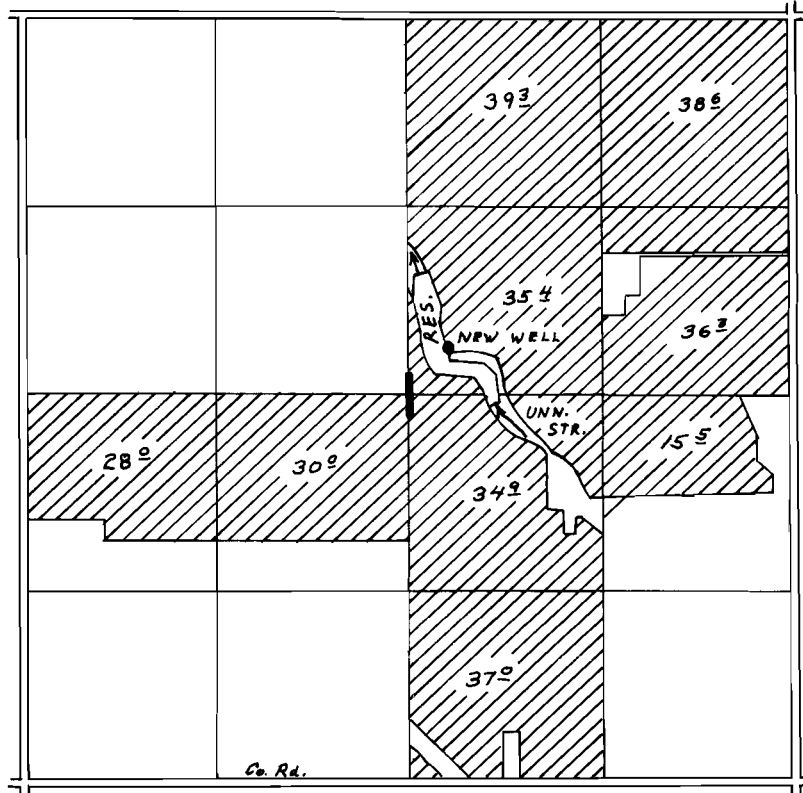

Div. Pt. Loc. 830' N. & 80' E. FROM CENTER SEC. 1

FINAL PROOF SURVEY UNDER

R-53368 R-6305
Application No. ~~53369~~ Permit No. ~~39377~~.....

IN NAME OF

..... JAMES BUTSCH

Surveyed MAY 1..... 1979., by L. H. NUNN.....