

# T6S. R5W. WM.

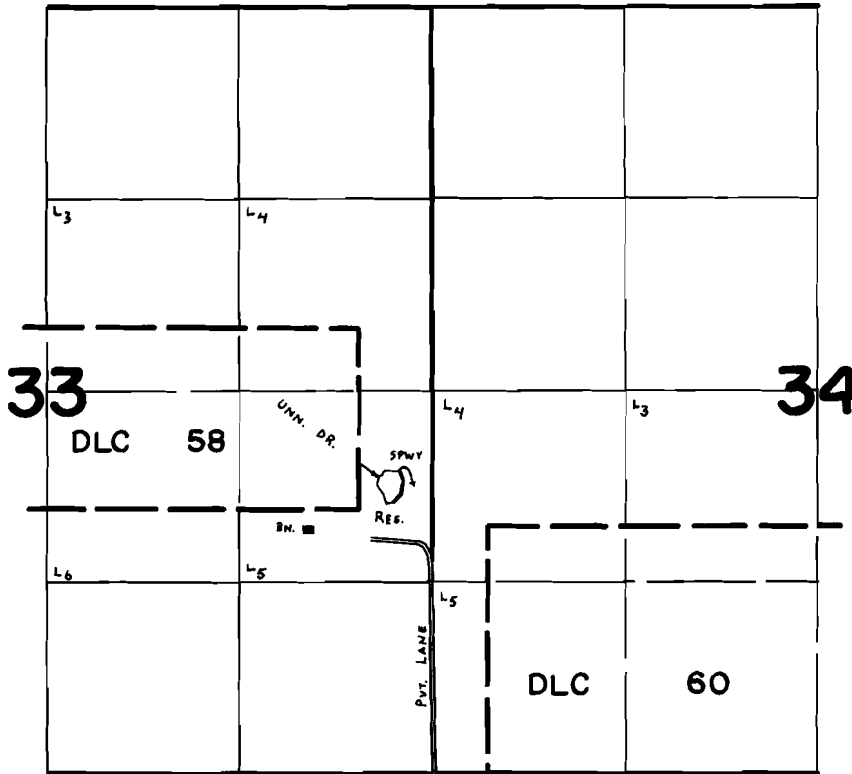

DAM Loc: 670'S. & 210'W. fr. E. 1/4 COR. Sec. 33.

## FINAL PROOF SURVEY UNDER

R-51559                      R-6241  
Application No. 51560. Permit No. 38826....

IN NAME OF

**DAVID HIEBENTHAL**

Surveyed May 18, 1979, by C. L. HUGHES...