

T.5S.,R.4W.,W.M.

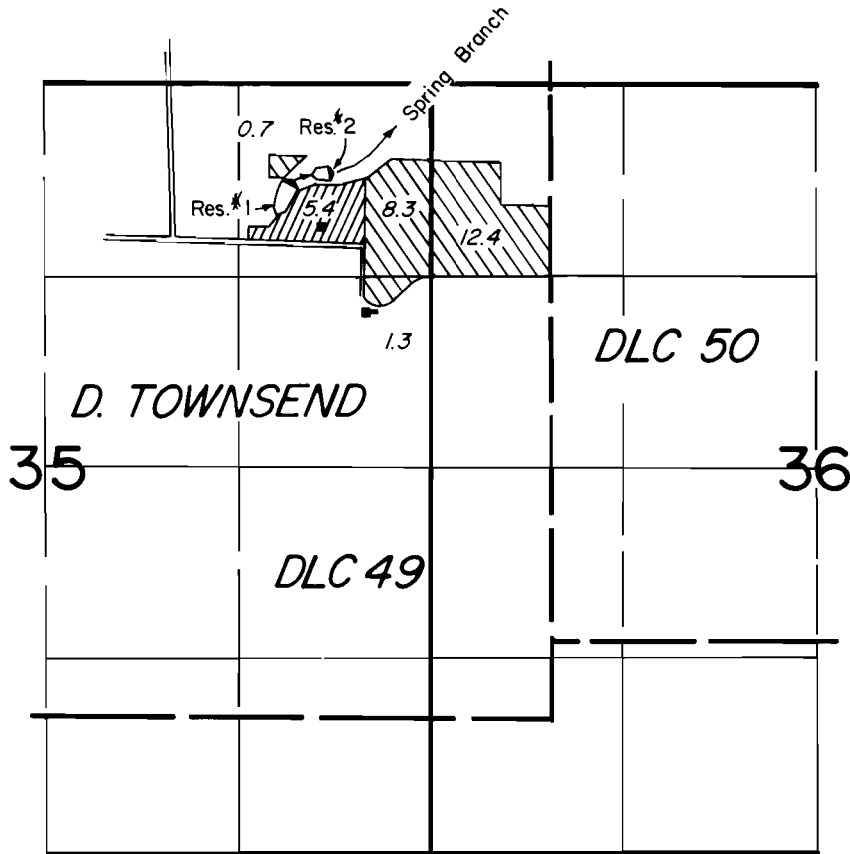

1-700'S E 950'W, 2-600'S E 600'W from NE cor SEC.35

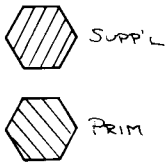

FINAL PROOF SURVEY UNDER

R-52930 R-6304
Application No. 52931 Permit No. 39374.....

IN NAME OF

DENNIS M. BRUTKE

Surveyed JUNE 7, 1980, by [Signature]