

T. 30S., R.5W., W.M.

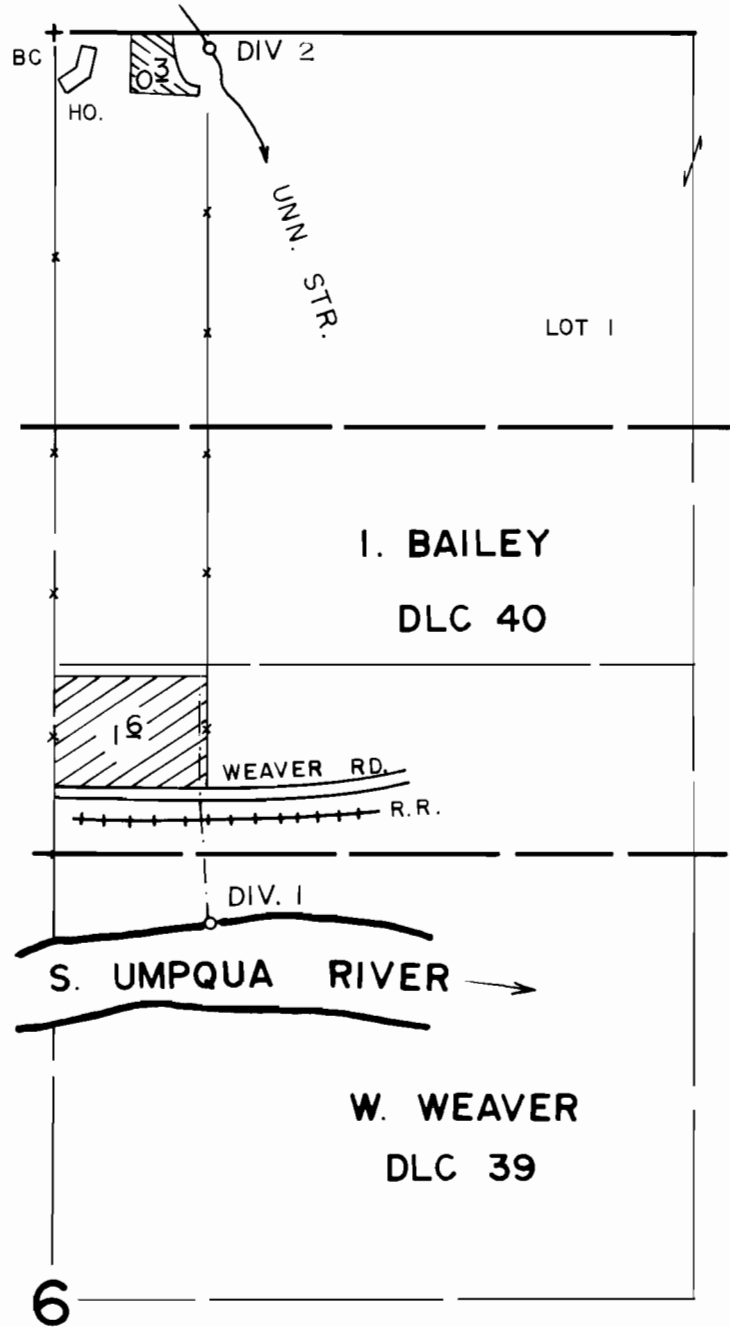

DIV. LOCATIONS :
 NO. 1 - 1860' S., 320' E.
 NO. 2 - 30' S., 320' E.
 from N. 1/4 CORNER
 SEC. 6

SCALE: 1" = 400'

6

FINAL PROOF SURVEY
 UNDER

Application No. ~~51996~~ Permit No. ~~39199~~.....
 IN NAME OF

GEORGE V. ROY

Surveyed MAY...30. 1984., by *J.E. Cashman*.....