

T.1S. R.44E. W.M.

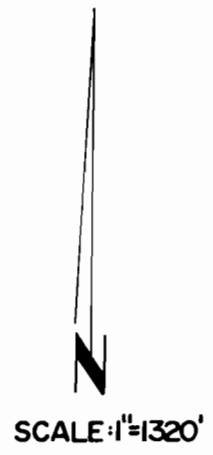

T.2S. R.44E. W.M.

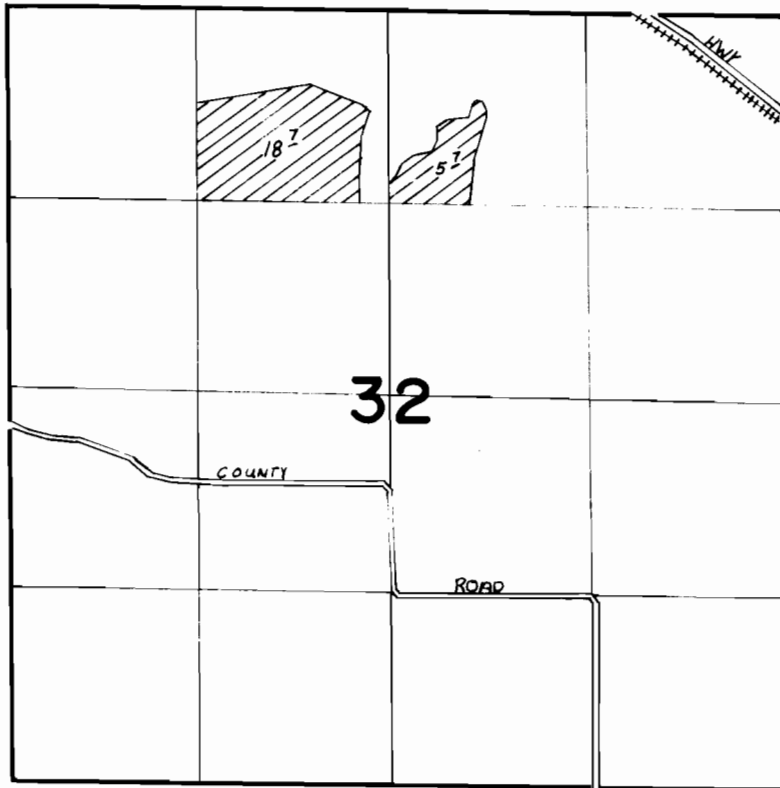
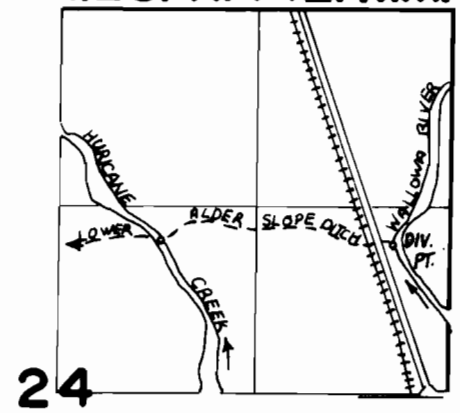

DIV. PT. LOCATED 390' W. AND 1030' N. FROM E. 1/4 COR. SEC. 24

FINAL PROOF SURVEY
UNDER

Application No. 52069.. Permit No. 39239.....
IN NAME OF

WALTER & the estate of HERMAN STEIN

Surveyed Aug. 6..... 1984... by V.L. CHURCH.....