

T.3S.R.9W.W.M.

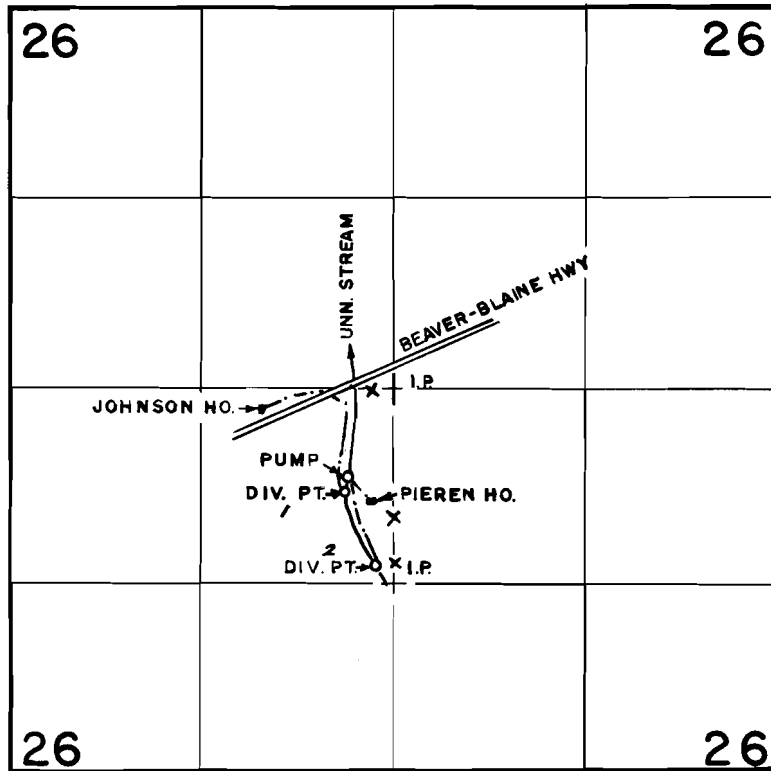

DIV. PTS. LOC. 700'S. & 340'W., 1200'S. & 120'W., BOTH FROM CEN. SEC. 26

FINAL PROOF SURVEY UNDER

Application No. 54713. Permit No. 41045.....
IN NAME OF

STEVEN L. PIEREN & GERTRUDE F. JOHNSON

Surveyed JAN 24 1980, by R.G. MUCKEN.....