

T. 2S., R. 44E., W.M.

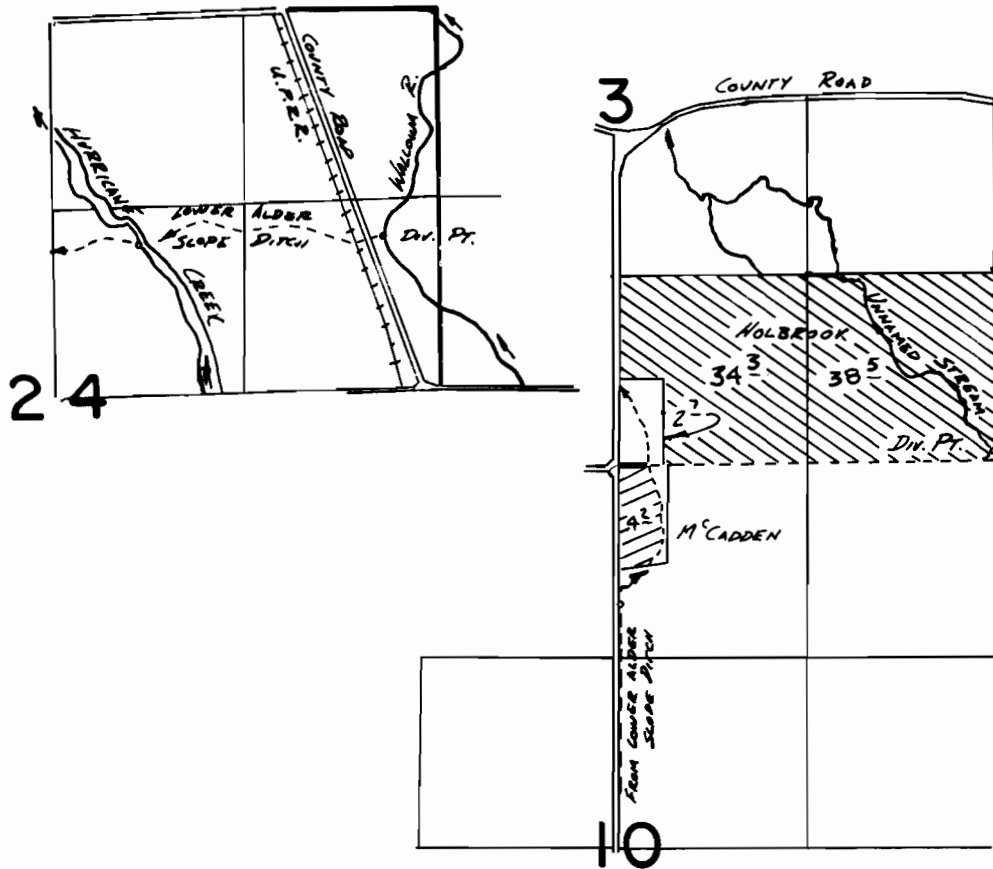

WALLOWA R. Div. Pt. 1550'S. & 370'W. FROM NE COR. SEC 24  
UNNAMED STREAM Div. Pt. 60'N. & 20'W. FROM SE COR. SEC 3

**FINAL PROOF SURVEY**  
UNDER

Application No. 54847 Permit No. 41143  
IN NAME OF

MIKEL TERRY HOLBROOK & FLOYD M'CADDEN

Surveyed 8-10 1982, by V.H. Church