

T. 3 N., R. 10 W., W.M.

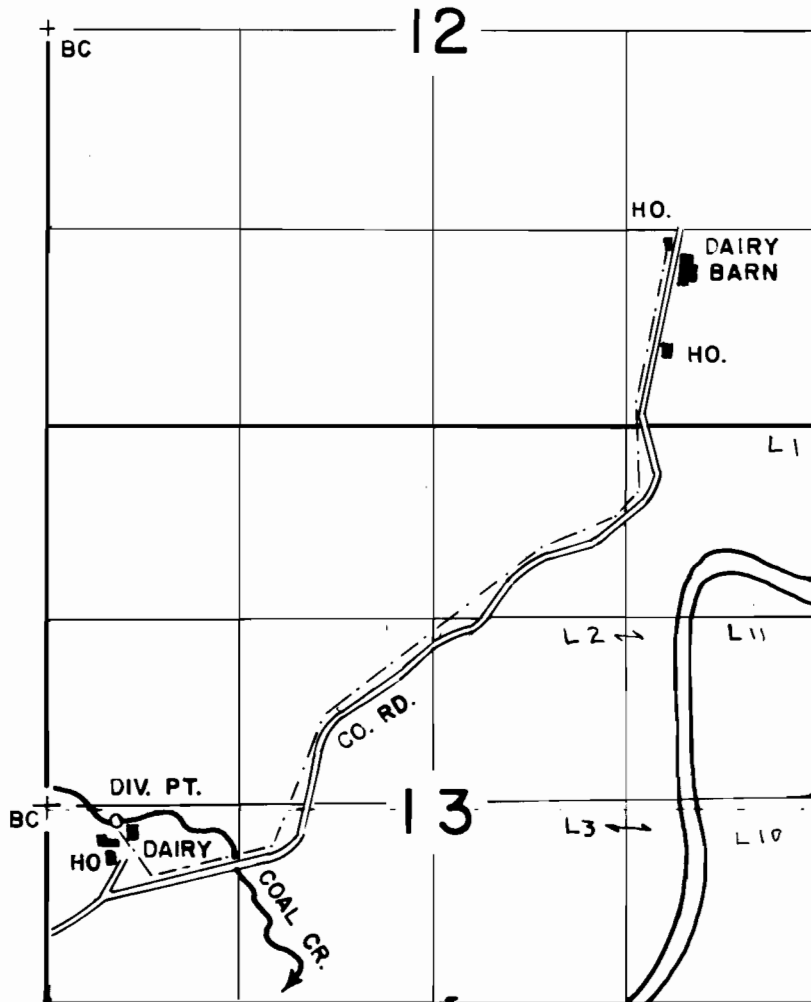

DIV. PT. LOC. 100' S & 460' E OF W 1/4 COR. SEC. 13

FINAL PROOF SURVEY UNDER

Application No. 59373... Permit No. 44881.....

IN NAME OF

RICHARD W. & LARAYNE WOODWARD

Surveyed MAY 22, 1984, by P. PAGTER.....